

# Xiaolei

## Super Smart Switch (6-Gang)



Manual

[www.xiaolei.com.cn](http://www.xiaolei.com.cn)

# Application Diagram

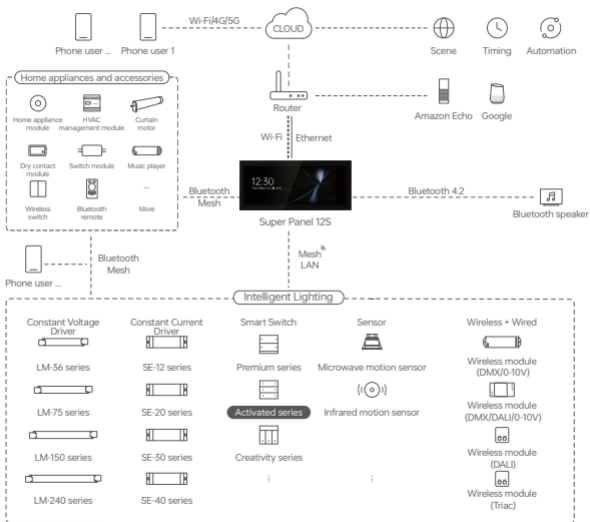

## Product Features

- Bluetooth 5.0 SIG Mesh with high networking capacity enables reliable and stable local control.
- Work with a Bluetooth LED driver to turn lights on/off, change brightness and colors.
- Work with a smart gateway to achieve various cloud scenes, cloud-based automation, and local automation.
- Support local scenes that can still run without the Internet or a gateway, faster and more stable.
- Multiple interaction methods. Single press/long press action control supported.
- Support battery check. When the battery on the panel is too low, the indicator light will flash that reminds you to replace the battery.
- Place the back of the switch into any magnetic field or stick it anywhere with a 3M adhesive. 400+ combination options for one row with integrative installation.

## Technical Specs

Model	S6-B
Wireless Type	Bluetooth 5.0 SIG Mesh
Power Supply	Battery Powered
Input Voltage	3V $\text{---}$ (Button Battery CR2032 $\times$ 2)
Working Temperature	-20 $^{\circ}$ C~55 $^{\circ}$ C
Working Humidity	$\leq$ 80%RH
Net Weight	75g
Dimensions	86 $\times$ 86 $\times$ 10.5mm (L $\times$ W $\times$ H)
Colors Available	Grey, Gold, White



RoHS

SRRC

## Product Images



## Product Size

Unit:mm

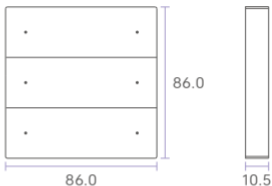

## Battery Replacement

Use a flat head screwdriver to remove the back cover of the panel. Replace the batteries with new ones(battery specification: CR2032), and then securely close the back cover.

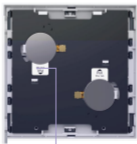
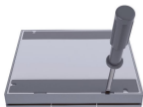

Remove the battery insulation sheets before use.



# Installation Methods

Method 1: Simply place the panel directly on the desktop.

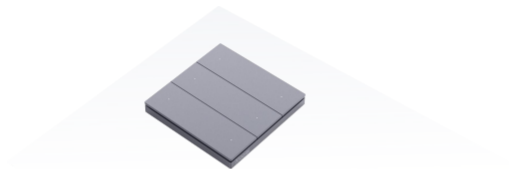

Method 2: Mount the bracket onto the wall either by drilling holes and securing it with KA 2.6 screws, or by using the provided 3M tape to stick the bracket to the wall. Finally magnetize the panel to the bracket to complete the installation.

① Fix the panel via screws



Magnetic bracket

② Stick it with a 3M tape

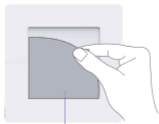

3M tape



## Recommended Applications

1. Connect to a Bluetooth LED driver to control the lamp wirelessly.

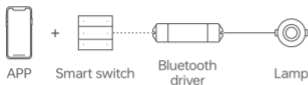

2. Connect to a Bluetooth curtain motor to intelligently open/close curtains.

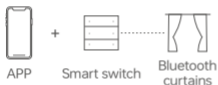

3. Support local scenes that can still run without the Internet or a gateway.

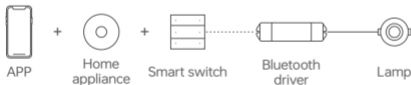

4. Connect to a smart gateway to achieve visual control, cloud scenes, and automated linkage.



5. Intelligent control. Set up more app configs as you like.

# App Operating Instructions

## 1. Register an account

Scan the QR code below with you mobile phone and follow the prompts to complete the app installation. Then open the App and log in or register an account.



## 2. Connect to the network

Create a home if you are a new App user. Click [ + ] icon in the upper right corner of “Room” interface to access “Add device” page. Pick [ Smart panel ] from the list and follow the on-screen prompts to add the device.

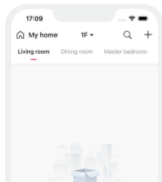

### 3. Bind devices

On the “Room” interface, click the added smart switch to enter the “Control” interface.

Short-press the corresponding button on the interface, select the binding target [ Device ], choose the short-press/long-press action, then click the “Save” button. Follow the on-screen prompts to activate the panel, and it will be completed when the interface shows “Saved successfully”.

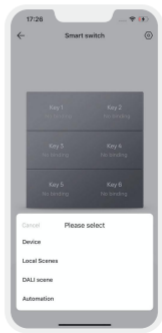
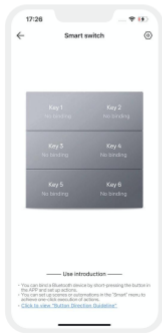

#### 4. Local scene

Create a local scene:

Switch to the [ Smart ] page, click “+” in the upper right corner to create a local scene, and after setting the execution action, you can realize the local linkage of Bluetooth devices.

Binding local scenes:

On the control details page, click on the corresponding key, and set the binding scene. Once saved successfully, a short press of the button will immediately execute the bound scene.

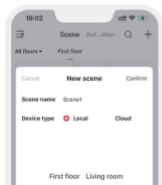

Create a local scene

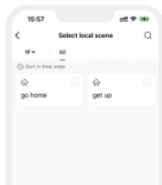

Binding a local scene

## 5. Cloud scenes and automation

Make sure that a smart gateway, such as Super Panel 12S, has been added to the family.

Cloud scenes:

Switch to the [ Smart ] interface and click “+” to create a cloud scene. After setting the execution action, remote linkage can be achieved.

Automation:

Select “Automation” in the [Smart ]page and click “+” to create automation. You can choose local/cloud execution mode, and set trigger conditions and execution actions. When the set trigger conditions are met, a series of device actions are automatically triggered to achieve remote linkage.

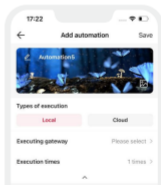
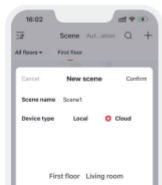

## FAQs

### 1. How to reset a switch to factory defaults?

- Long press any button on the smart switch for 15 seconds until the indicator light flashes fast and release it. Then short press the same button three times within 3 seconds. When the indicator light flashes, the device has been reset to factory defaults.

### 2. What should I do if I fail to search the device via APP?

- Please make sure the device is powered on normally and is in the activated state.
- Please keep you mobile phone and device as close as possible. The recommended distance between them is no more than 15 meters.
- Please make sure the device hasn't been added yet. If it has, please reset the device to factory defaults manually.

### 3. Why do the indicator lights of Key 1 and Key 2 flash 5 times during operation?

- It reminds that the battery is low and should be timely replaced.

## Attentions

- Product installation and commissioning should be done by a qualified professional.
- LTECH products are and not lightningproof non-waterproof (special models excepted).
- Please avoid the sun and rain. When installed outdoors, please ensure they are mounted in a water proof enclosure or in an area equipped with lightning protection devices .
- Good heat dissipation will prolong the working life of products. Please ensure good ventilation.

- Please check if the working voltage used complies with the parameter requirements of products.
- The diameter of wire used must be able to load the light fixtures you connect and ensure the firm wiring.
- Before you power on products, please make sure all the wiring is correct.
- If a fault occurs, please do not attempt to fix products by yourself. If you have any question, please contact your suppliers.

## Warranty Agreement

- Warranty periods from the date of manufacture: 2 years.
- Free repair or replacement services for quality problems are provided within warranty periods.

Warranty exclusions below:

Following conditions are not within the guarantee range of free repairing or replacement services:

- Beyond warranty periods.
  - Any artificial damage caused by high voltage, overload, or improper operations.
  - Products with severe physical damage.
  - Damage caused by natural disasters and force majeure.
  - Warranty labels and barcodes have been damaged.
  - No any contract or invoice signed by LTECH .
1. Repair or replacement provided is the only remedy for customers. LTECH is not liable for any incidental or consequential damage unless it is within the law .
  2. LTECH has the right to amend or adjust the terms of this warranty. The warranty that issues in writing shall prevail.
- \* This manual is subject to changes without further notice. Product functions depend on the goods. Please feel free to contact our official distributors if you have any question.

# Xiaolei

## 超级智能开关 (六键)



使用说明书

[www.xiaolei.cn](http://www.xiaolei.cn)

# 系统图

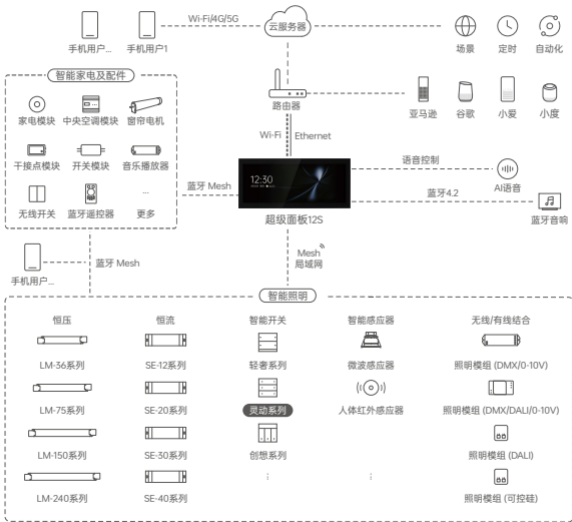

## 产品介绍

- 蓝牙 5.0 SIG Mesh 通信协议，组网能力强，本地控制可靠稳定；
- 搭配蓝牙驱动器，实现灯光开关、调光、调色控制；
- 搭配智能网关可实现丰富的云场景、云自动化、本地自动化控制方式；
- 支持本地场景，去网关，断网可控，更快更稳定；
- 多方式交互，支持单击/长按动作控制；
- 支持电量检测，当面板电量过低时指示灯闪烁提醒，更换电池；
- 背部采用磁吸或3M胶可自由粘贴随心放置；400+联排组合，一体化安装。

## 规格参数

产品型号	S6-B
无线类型	Bluetooth 5.0 SIG Mesh
供电方式	电池供电
输入电压	3V $\pm$ (纽扣电池CR2032 $\times$ 2)
工作温度	-20 $^{\circ}$ C~55 $^{\circ}$ C
工作湿度	$\leq$ 80%RH
产品净重	75g
产品尺寸	86 $\times$ 86 $\times$ 10.5mm (L $\times$ W $\times$ H)
颜色类型	莫奈灰、梵高金、雷曼白



Bluetooth<sup>®</sup>



RoHS

SRRC

## 产品图示



## 产品尺寸

单位: mm

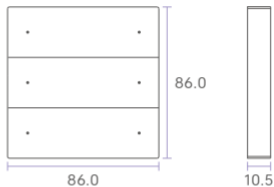

## 电池更换

使用一字螺丝刀将面板底盖撬开，更换电池（电池规格：CR2032）后重新盖上底盖。

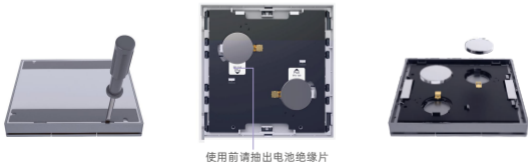

# 安装方式

方式一：可将面板直接放置于桌面使用。

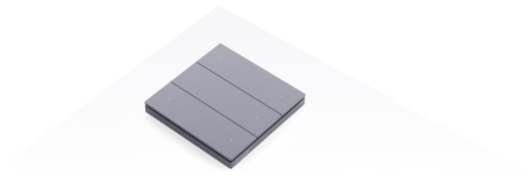

方式二：使用KA2.6螺丝将支架固定在墙面，或使用附赠的3M胶布，将磁吸支架粘贴在墙面上，最后将面板磁吸到支架上，实现面板墙面安装。

## ①螺丝固定



## ②3M胶布粘贴

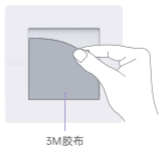

## 应用组合

1. 搭配蓝牙驱动器，实现无线控制灯具。



2. 搭配蓝牙窗帘电机，实现智能开合窗帘。



3. 支持本地场景，去网关，断网可控。



4. 搭配智能网关，实现可视化控制，云场景、自动化联动。



5. ...智能控制，更多应用搭配等您来设置。

# APP操作说明

## 1. 账号注册

通过手机扫描下方二维码，按提示完成APP安装后即可进行登录/注册操作。



## 2. 配网操作

新用户用户在APP上创建家庭后，在“房间”界面点击右上角【+】进行添加，在添加设备列表中选择【智能面板】后，按照界面提示完成添加即可。



### 3. 绑定设备

在“房间”界面点击已添加的智能开关进入“控制”界面。

短按界面中对应按键，选择绑定对象【设备】并选择短按/长按动作后，点击“保存”按钮，按照界面提示激活面板，当界面提示“保存成功”即可。



#### 4. 本地场景

创建本地场景：

切换到【智能】界面，点击右上角“+”创建本地场景，设置执行动作后，即可实现蓝牙设备的本地联动。

绑定本地场景：

在控制详情页面，点击对应按键并设置绑定场景，保存成功后，通过短按按键立即执行所绑定的场景。



创建本地场景



绑定本地场景

## 5. 云场景与自动化

确保家庭内已添加智能网关，如超级面板12S。

云场景：切换到【智能】界面，点击“+”创建云场景。设置执行动作后，即可实现远程联动。

自动化：在【智能】界面中选择“自动化”，点击“+”创建自动化。可选择本地/云端执行方式，以及设置触发条件及执行动作。当满足已设置的触发条件时，自动触发一系列设备动作，实现远程联动。



## 常见问题

### 1.如何恢复出厂设置？

- 长按智能开关任意按键15秒，直至指示灯快闪后松开，3秒内短按同一按键3次，指示灯闪烁，设备已恢复出厂设置。

### 2. 设备一直搜索不到怎么办？

请检查以下选项：

- 确保设备已抽出内部绝缘片，设备能正常通电；
- 确保手机与设备两者尽量靠近，建议不超过15米；
- 确保设备未被添加过，如有添加过，请恢复出厂再次进行添加。

### 3. 为什么操作时按键1、按键2的指示灯会闪烁5次？

- 提醒电池处于低电量状态，应及时更换设备电池。

## 注意事项

- 请由具有专业资格的人员进行调试安装。
- 雷特产品（专有型号除外）不能防水防雷，需避免日晒雨淋，如安装在户外，请用防水箱和防雷装置。
- 良好的散热条件会延长产品的使用寿命，请把产品安装在通风良好的环境。
- 请检查使用的工作电压是否符合产品的参数要求。
- 使用的电线直径大小必须能足够负载连接的LED灯具，并确保接线牢固。
- 通电调试前，应确保所有接线正确。
- 如果发生故障，请勿私自维修；如有疑问，请联系供应商。

## 保修条例

- 自出厂之日起保修服务期为2年。
- 在保修服务期内出现产品质量问题雷特科技将给予免费修理或更换服务。

### 非保修条例：

属下列情况不在免费保修或更换服务范围之内：

- 已经超出保修服务期；
  - 过高电压、超负载、操作不当等人为造成的损坏；
  - 产品外形严重损坏或变形；
  - 自然灾害以及人力不可抗拒原因造成的损坏；
  - 产品保修标签和产品唯一条形码损坏；
  - 无雷特科技签订的合同或发票凭证。
1. 修理或更换是雷特科技对客户唯一补救措施。雷特科技不承担任何附带引起的损害赔偿，除非在适用法律范围之内。
  2. 雷特科技享有修正或调整本保修条款的权利，并以书面形式发布为准。
- \* 本说明书的内容如有变更，恕不另行通知。若内容与您使用的功能有所不同，则以实物为准。如有疑问，欢迎向我司授权的经销商咨询。