

Super Panel 6S

Manual
www.xiaolei.com.cn

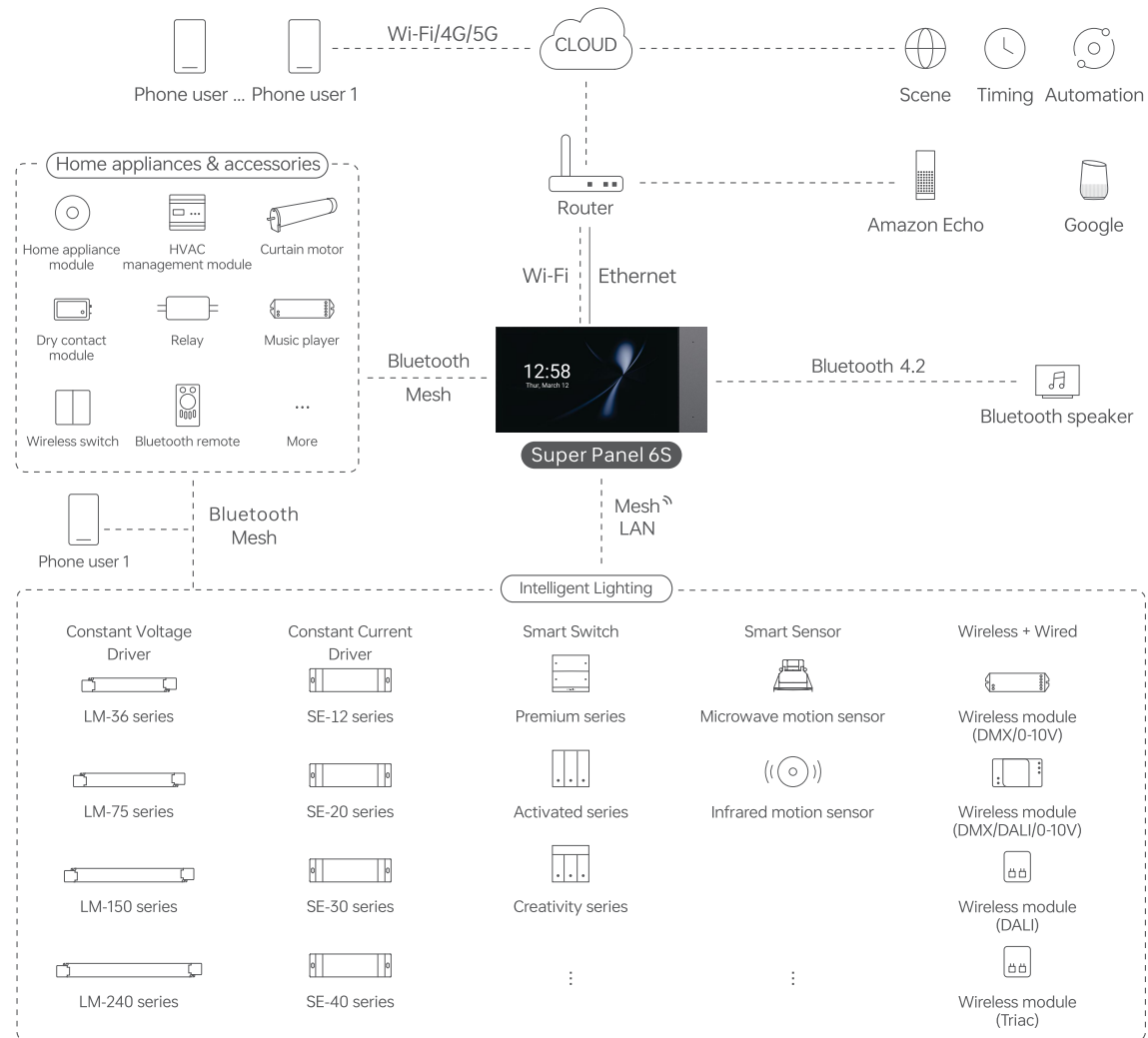

Application Diagram



Product Introduction

Super Panel 6S is a central smart home control panel, featuring a 6-inch IPS screen with 1280×720 resolution. It is compatible with Wi-Fi 2.4G + 5G, Ethernet and Bluetooth 5.0 SIG Mesh communication. Super Panel 6S can act as a 2 channels relay to directly control load lamps. With IR capability, it is capable of controlling all your IR home appliances and turning traditional home appliances into smart ones.

Super Panel 6S comes with a built-in 2-in-1 light and proximity sensor that enables auto screen brightness adjustment, as well as auto screen wake up when nearby people approach it. It combines button, touchscreen and App interaction. Preset multi-function scenes can be performed just by one button. In addition to this, it supports local control without the network needed, which performs faster and more stably.

It is installed in the 86 type junction box and enables more than 400 flexible panel combinations by using unified panel mounting frames.

Technical Specs

Model	SP-GW-6S
Wireless network	Bluetooth 5.0 SIG Mesh, Wi-Fi 2.4G+5G
Wired network	Ethernet
Power supply	100-240V~, 50/60Hz, USB Type-C cable powered, 5V=2A
Display	6-inch full lamination, 1280×720 resolution
Touchpad	Capacitive multi-touch screen, anti-fingerprint coating
Materials	PC+ V0 fireproof grade
Single load	LED≤200W, \varnothing ≤400W
Channel of load	2 Channels
Inrush current in loads	Max.65A@2ms
Working environment	-15°C~50°C, Humidity≤85%RH
Dimensions	L172×W86×H41(mm)
Package size	L218×W132×H75(mm)
Junction box	86 type
Colors	Grey, Gold, White

Package Contents

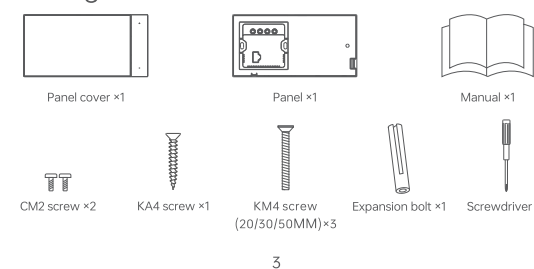

Recommended Applications

1. Connect to a lamp and get fast lamp control.
2. Connect to a traditional lamp and add Super Panel 6S to the APP, so you can intelligently control the lamp.
3. Add Super Panel 6S to the APP to realize remote control (via 4G, 5G, Wi-Fi) + local control of the lamp.
4. Work with a Bluetooth LED module to realize wireless + wired control of the lamp.
5. Work with a home appliance module to control lamps, air conditioning, curtain motors and more devices, and to realize various automation.
6. Control the lamp either with APP, Super Panel 6S or a remote, a wireless switch or a home appliance module.
7. More applications of intelligent control are waiting for you to set up.

Product Overview

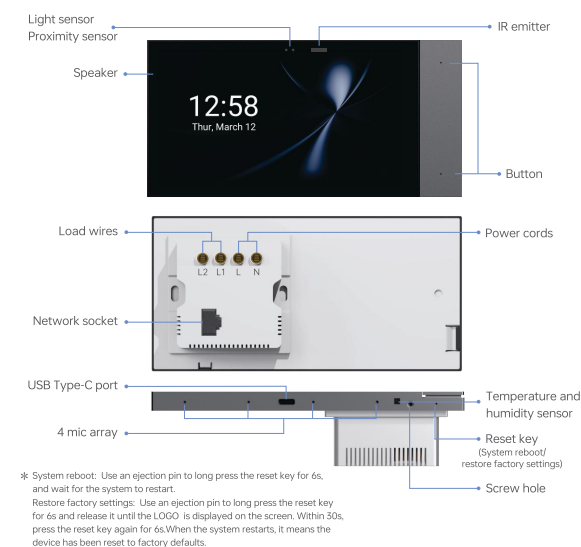

Product Size

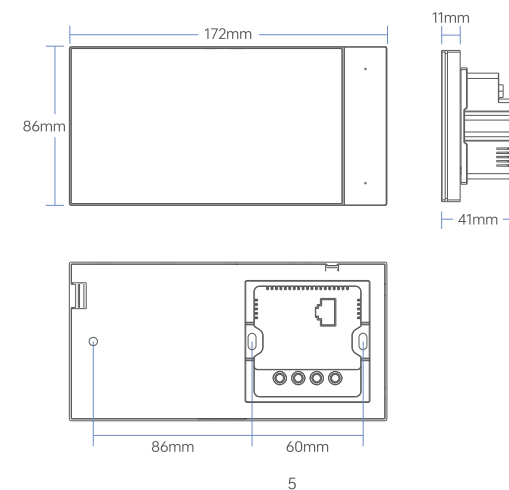

Installation Steps

1. AC-powered
 - 1.1 Turn off the circuit breaker and remove any concrete or corrosion that are inside the 86 type wall box. Trim each wire in the wall box to about 10cm in length.
 - 1.2 Wire the panel
 - Attach the live line to L socket of the panel, the null line to N socket and the load wires the lights to L1/L2 port. Make sure the wires are well connected to the switch terminals with no copper wire exposed. If necessary, insert a network cable into the network socket.
 - (The protection device for the electronic switch cannot be greater than 35A)
 - 1.3 Install the panel
 - Method 1: Plan one wall box in advance
 - Mark the position of the KA4 screw hole on the wall first and drill a hole, then insert the expansion bolt into this screw hole. Place the KA4 screw into the bolt through the panel frame and secure the screw to fit the panel frame to the wall with a screwdriver; Next use KM4 screws to secure the panel box to the wall box.
 - Note: Make sure the panel frame is stable and won't appear crooked.

Method 2: Plan two wall boxes in advance
 Insert the KM4 screw and secure it to fit the panel frame to the wall with a screwdriver; Then use KM4 screw to secure the panel box to the wall box.
 Note: Make sure the panel frame is stable and won't appear crooked.



1.4 Snap on the panel cover
 Slant the left side of the panel cover and snap it to the panel frame. Then secure the panel cover to the frame from the bottom with a CM2 screw.



2. Install multiple panels into one
 When you use the panel mounting frame to combine two/three/four Super+ series panels on the same row, some common installation issues can be easily solved, such as installing panels upside down, space inconsistency between panels, the left panel not aligning with the right.
 For the detailed installation method, please refer to the panel mounting frame manual.
 * Panel mounting frame and Super Panel 6S are sold separately.

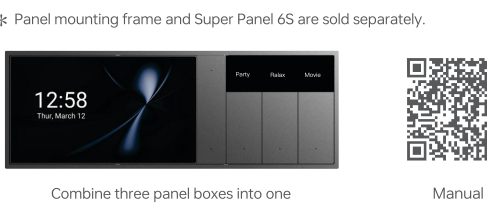

Combine three panel boxes into one Manual

3. Installation Precautions for Row-mounted Devices

Note: The Super Panel 6S must be installed on the far left; otherwise, it will affect the normal operation of the speaker.



Do not block the speaker

Instructions to use Super Panel 6S

- Swipe down from the top of the screen to access the control center; swipe up to close it.
- Swipe left from the right side of the screen to access the button usage guidelines; swipe right to close it.
- Customize the home page style by long pressing the cards and dropping them on the home page.

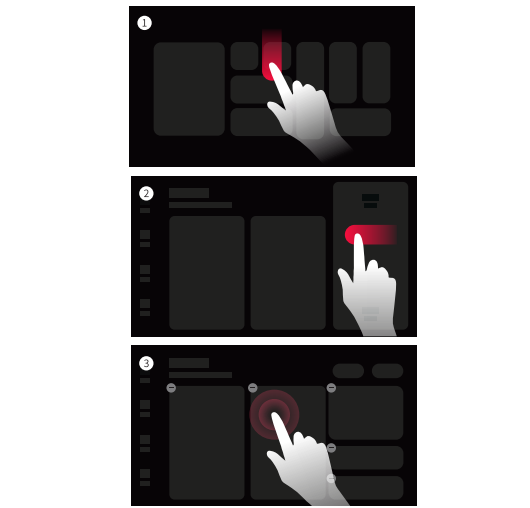

8

App Operating Instructions

1. Register an account
 1.1 Scan the QR code below on the left with your mobile phone. Follow the prompts to complete the app installation and log in or register an account.
 1.2 For more App operating instructions, please scan the QR code below on the right.

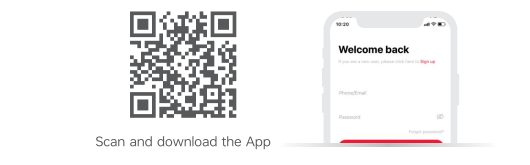

Scan and download the App

2. Configure the Super Panel 6S

Power on the Super Panel 6S and wait for a while to start it up. Follow the page guidelines of the panel to connect it to the Wi-Fi. Once connected successfully, a QR code for the device will be displayed on the interface and you'll be able to complete the configuration.

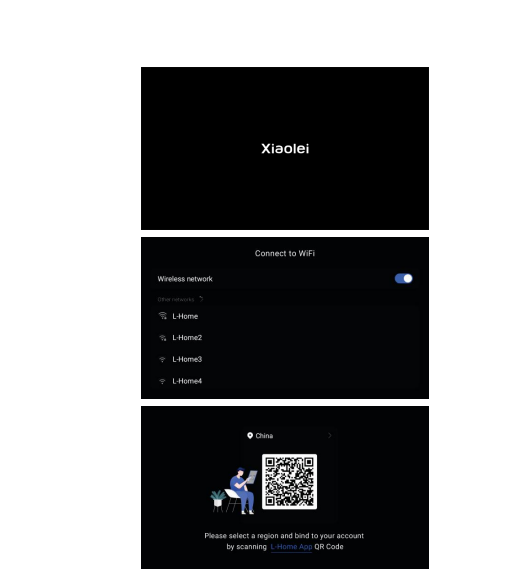

9

3. Bind your account

Create a home if you are a new user. Then click "+" icon in the upper right corner to access the "Add device" page. Pick "Smart gateway-Super Panel 6S" from the device list and follow the prompts to scan the QR code displayed on the Super Panel 6S screen, then complete your account binding.

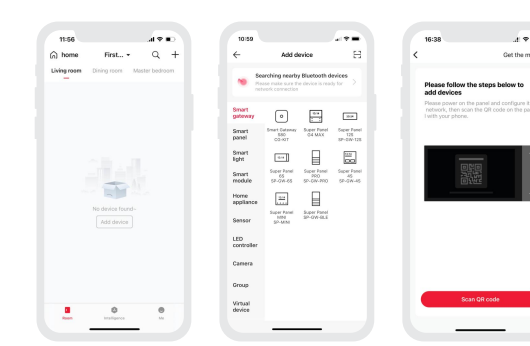

Scan and download the App

4. Add infrared devices

Go to the Super Panel 6S interface and click "Infrared appliance", then tap "+" icon in the upper right corner. Follow the prompts in APP to select your infrared home appliances according to the appliance type and brand. After completing the setting, you can directly control the infrared home appliances with the Super Panel 6S.

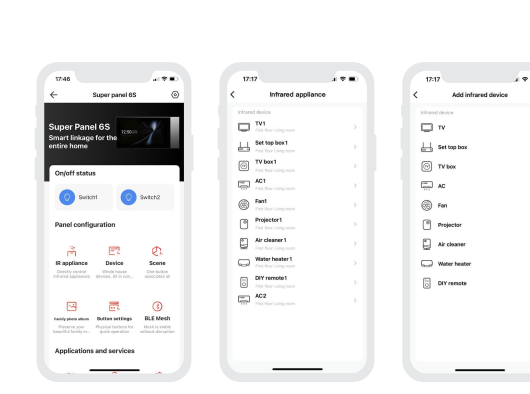

10

5. Control devices with the Super Panel 6S

Please refer to manuals of related products. Follow the prompts to add the devices you want and access the Super Panel 6S interface. Click "Device" to go to "Displayed devices" interface. Then click the icon in the upper right corner to pick the devices you want to control with the Super Panel 6S and save them.

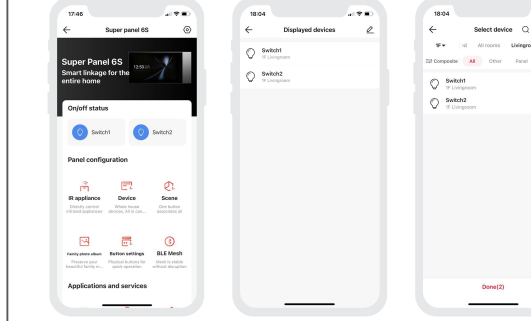

Scan and download the App

6. Control scenes with the Super Panel 6S

Create scenes: Get back to the homepage of the App. Switch to "Intelligence" menu and click "+" icon to add scenes. Follow prompts to modify names and icons for scenes, and click "Add action" to set up the action and delay time you want.
 Displayed scenes: Go to the Super Panel 6S interface and click "Scene" to access "Displayed scenes" interface. Click the icon in the upper right corner to add the scenes you want to control with the Super Panel 6S.

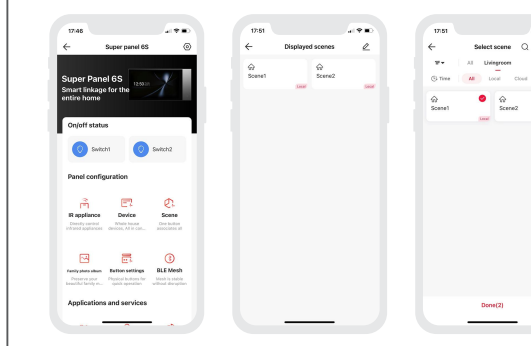

11

7. Set up the relay (Switch 1/Switch 2)

In the "Room" interface, click the blank area of the Super Panel 6S card to get a popup and control Switch 1/Switch 2 quickly. Or you can go to the Super Panel 6S interface to turn Switch 1/Switch 2 on or off by tapping them. Go to the Super Panel 6S settings and click them to name the relay (Switch 1/Switch 2).

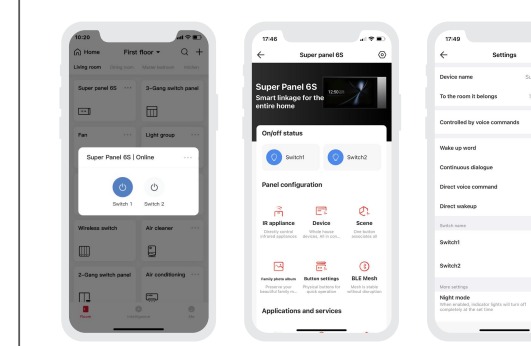

Scan and download the App

8. Set up the physical buttons

Go to the Super Panel 6S interface and click "button settings". Tap the button you want and follow the prompts to set up the device action or scene performed by this button.

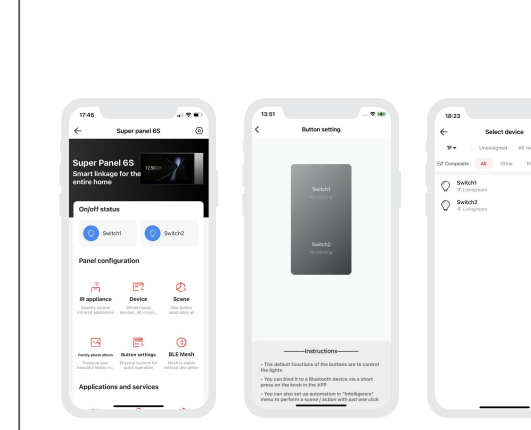

12

FAQs

1. How to change the user account ?
 Super Panel 6S has one standard user account only. The Super Panel 6S that has been added needs to be deleted by the original owner before your login.
2. How to restart the device?
 Use an ejection pin to long press the reset key for 6s, and wait for the system to restart.
3. How to reset the device to factory defaults?
 Use an ejection pin to long press the reset key for 6s and release it until the LOGO is displayed on the screen. Within 30s, press the reset key again for 6s. When the system restarts, it means the device has been reset to factory defaults.

Attentions

- The installation location should avoid being close to large-area metal objects against signal interference.
- Please use in a cool and dry environment, please keep away from heat.
- Please do not open, change or repair, otherwise the warranty is not allowed.

* This manual is subject to changes without further notice. Product functions depend on the goods. Please feel free to contact our official distributors if you have any question.

Warranty Agreement

Warranty periods from the date of delivery: 2 years.
 Free repair or replacement services for quality problems are provided within warranty periods.

- Warranty exclusions below:
- Beyond warranty periods.
 - Any artificial damage caused by high voltage, overload, or improper operations.
 - Products with severe physical damage.
 - Damage caused by natural disasters and force majeure.
 - Warranty labels and barcodes have been damaged.
 - No any contract signed by LTECH.

1. Repair or replacement provided is the only remedy for customers. LTECH is not liable for any incidental or consequential damage unless it is within the law.
2. LTECH has the right to amend or adjust the terms of this warranty, and release in written form shall prevail.

Super Panel 6S 超级面板6S

使用说明书
www.xiaolei.cn



系统图

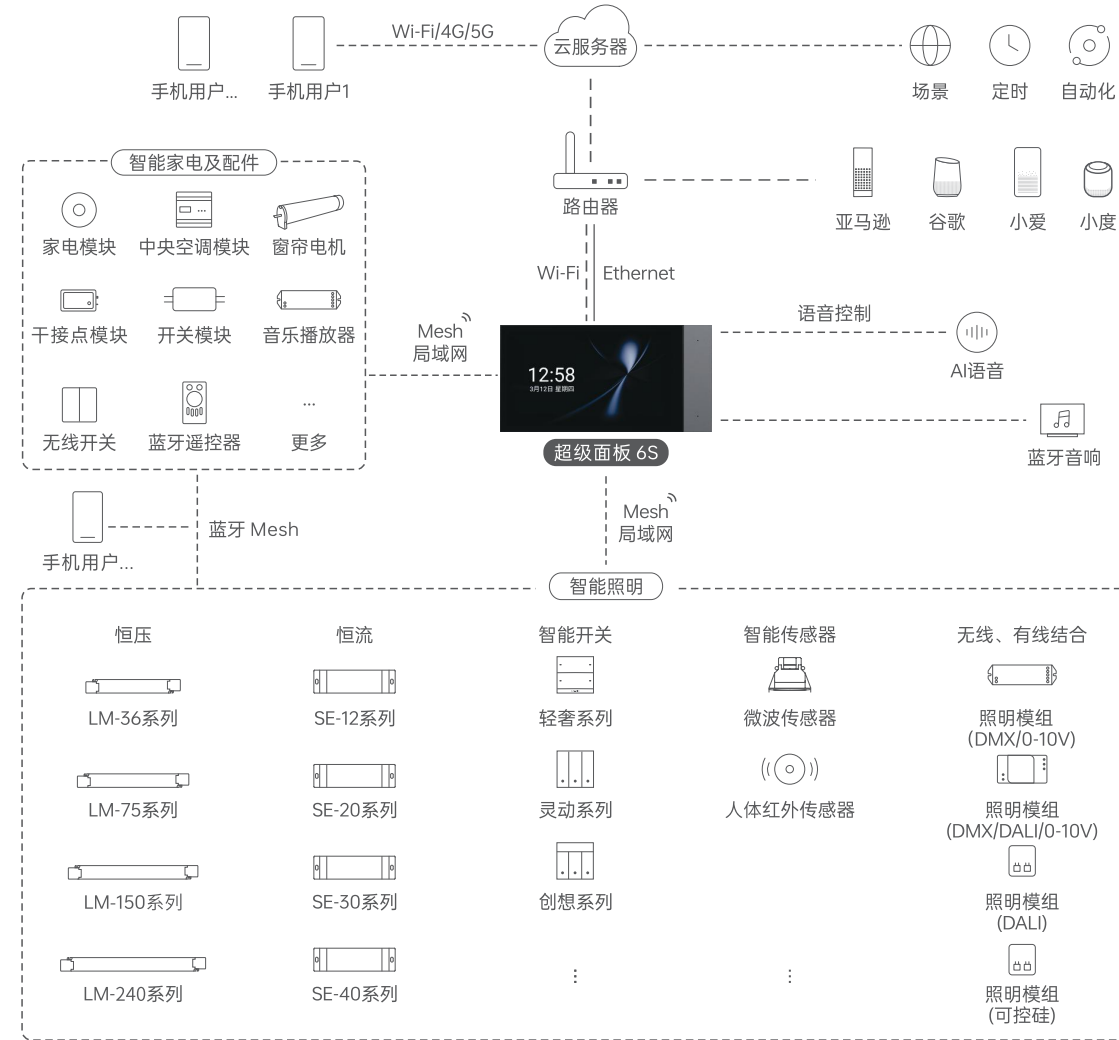

欢迎使用

Super Panel 6S是一款6英寸的智能家居控制面板，拥有1280×720高清IPS屏，画质清晰细腻。兼容5G和2.4G双频Wi-Fi、蓝牙5.0 SIG Mesh及以太网多种通讯方式，具有两路继电器可直接控制负载灯具，以及具有红外控制能力，实现传统灯具秒变智能家电。产品采用深度降噪的4麦克风阵列，支持10米超远场拾音，内置光感距离二合一传感器，可自适应调节亮度和人体靠近屏幕自动唤醒功能，搭载咪咕音乐平台，高品质正版音乐无限畅听。支持按键、触屏、语音及APP四大交互，预设多功能场景一键即达，轻松实现近、中、远场控制，还可以支持本地化控制，实现断网亦可控、更快更稳定的智控功能。标准86底盒设计，搭配一体式联排边框，400+种联排组合随心配。

技术参数

型号	SP-GW-6S
无线网络	Bluetooth 5.0 SIG Mesh, Wi-Fi 2.4G+5G
有线网络	以太网
供电方式	100-240V~, 50/60Hz; Type-C数据线供电, 5V=2A
显示屏	6.0英寸全贴合, 1280×720分辨率
麦克风	4麦克风阵列
触控层	电容式多点触控, 防指纹涂层
扬声器	AAC 1813 喇叭
机身材质	PC+V0防火级别
单路负载	LED≤200W, 白炽≤400W
负载路数	2路
负载抗浪涌电流	Max. 65A@2ms
工作温度	-15°C~50°C, 湿度≤85%RH
产品尺寸	L172×W86×H41(mm)
包装尺寸	L218×W132×H75(mm)
安装底盒	标准86底盒
颜色类型	莫奈灰、梵高金、雷曼白

包装清单

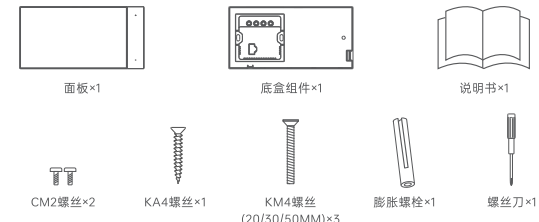

推荐应用搭配

- 超级面板6S连接灯具，可实现快捷控制灯具。
- 超级面板6S连接传统灯具后，APP添加超级面板6S，可实现智能控制灯具。
- APP搭配超级面板6S，实现远程（4G、5G、Wi-Fi）+本地局域网两种模式控制灯具。
- 超级面板6S搭配蓝牙无线模块可实现无线+有线控制，丰富灯光应用。
- 超级面板6S搭配家电模块控制灯具、空调、窗帘电机等设备，实现丰富的自动化控制。
- APP，智能面板，遥控，无线开关，家电模块都可控制灯具。
- ...智能控制，更多应用搭配等你来设置。

产品图示

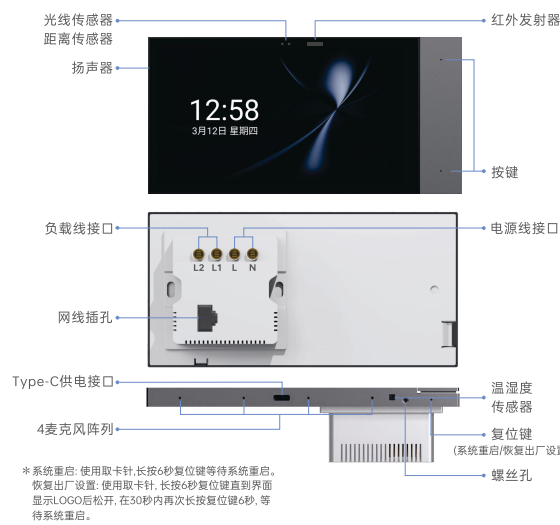

产品尺寸

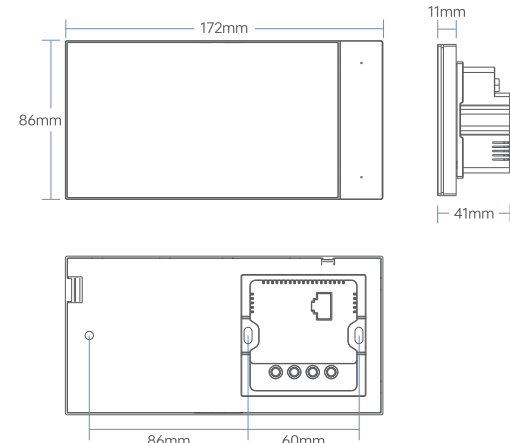

安装方法

- 市电供电
 - 关闭电源总闸，并确认86暗盒内壁无水泥石等附着物，将暗盒内的电源线长度修减至10CM左右。
- 接线
 - 将火线接入面板底壳的L接口，零线接入底壳的N接口，负载线接入底壳L1/L2接口，确认电源线与开关接线柱接触良好，无裸露铜线。如需接网线，将网线接入网线插孔。（电子开关的前置保护装置不能高于35A）
- 组装方式
 - 预留一个暗盒
 - 在墙面标记螺丝孔位并打孔装入膨胀螺栓后，在支架左侧螺丝孔位使用KA4螺丝使支架贴合墙面；用KM4螺丝将电源盒固定在墙壁暗盒上。注意：固定好支架使其不晃动，并保持平整不变形。

(2)预留两个暗盒

在支架左右两侧螺丝孔位使用KM4螺丝使支架贴合墙面；用KM4螺丝将电源盒固定在墙壁暗盒上。

注意：固定好支架使其不晃动，并保持平整不变形。



4.扣合面板

倾斜面板左侧并扣合在支架上，用CM2螺丝从面板底部将面板支架锁紧。

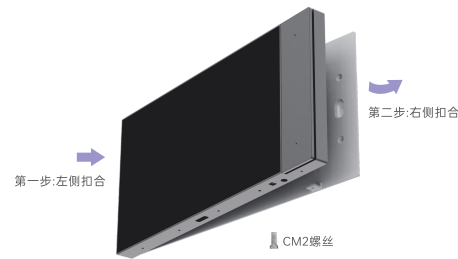

二、联排安装

可搭配一体式联排边框(二联排、三联排、四联排)，解决多个Super+系列面板安装时，上下错位、左右间隙不一，对齐麻烦等问题，上百种组合随心配。

具体安装方法请查看联排边框说明书

* 联排框与Super Panel 6S不配套销售



三联排示意图



说明书

三、联排安装注意事项

注意：超级面板6S必须安装在最左侧，否则会影响扬声器正常工作。



使用说明

一、手势操作

- 从屏幕顶部向下滑动，可展开控制中心；向上滑动可收起。
- 从屏幕右侧向左滑动，可展开物理按键指引；向右滑动即可收起。
- 在首页长按卡片，可自定义首页样式。

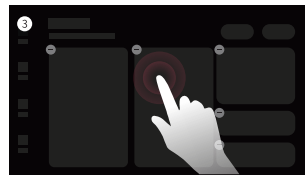

二、语音控制

可以语音唤醒后说出语音技能。不仅可以语音控制设备，还可以听音乐、听新闻等。更多语音技能，可通过超级面板6S【控制中心】-【设置】-【语音控制】-【语音指引】查看。



APP操作指引

1. 账号注册

- 通过手机扫描下方二维码，按提示完成APP安装。
- 打开APP进行登录/注册操作。



扫码下载APP



2. 配置超级面板6S

将超级面板6S接通电源，等待设备启动。根据超级面板页面指引，连接设备工作的Wi-Fi。连接成功后，界面呈现出设备二维码，完成配置。



3. 账号绑定

新用户在上APP上创建家庭后，在【房间】界面点击右上角“+”进入添加设备，在添加设备列表选择“智能网关-超级面板6S”后，按照界面提示，扫描超级面板6S上的二维码，完成绑定。



4. 如何添加红外设备

进入超级面板6S的界面，点击“智能遥控”，点击右上角“+”，根据APP提示选择家电类型和品牌后完成添加，即可通过超级面板6S控制红家电。

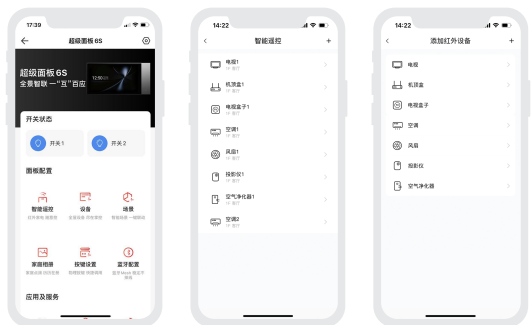

5. 如何在面板上控制设备

请参照相关产品的说明书，按照提示添加完成设备。进入超级面板6S的界面，点击“设备”进入显示设备界面。点击右上角图标，勾选您要在超级面板6S上控制的设备后，点击保存即可在超级面板6S上控制该设备。

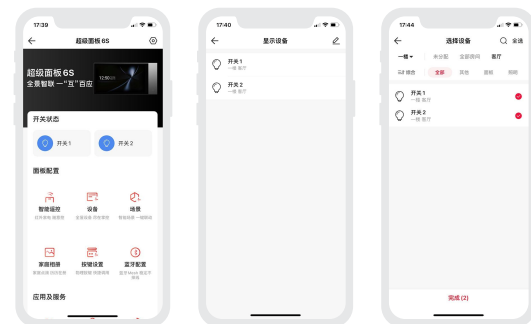

6. 如何在面板上控制场景

创建场景：切换到【智能】菜单，点击右上角“+”创建场景，按照提示可以修改场景名称、图标等。点击“添加动作”设定您想要的动作以及延时时间。显示场景：进入超级面板6S界面，点击“场景”进入显示场景界面。点击右上角图标，添加您要在超级面板6S上控制的场景即可。

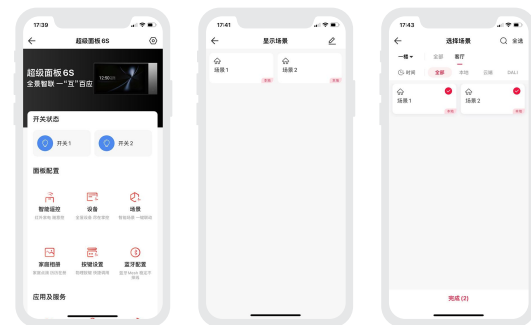

7. 继电器设置

在【房间】页面，点击超级面板卡片空白处弹出继电器快捷控制，或进入超级面板6S的界面，点击开关1/开关2可控制两路继电器的开/关，或进入超级面板6S的设置界面，点击对应的按键，可修改继电器的名称。



8. 物理按键设置

进入超级面板6S的界面，点击“按键设置”进入设置界面。点击对应的按键，根据提示可以设置当前按键执行的设备动作/场景。



常见问题及回答

1. 如何更换账号？

超级面板6S采用一对一账号体系，被添加过的设备需要原主人删除后，才能重新添加。

2. 如何重启设备？

使用取卡针，长按6秒复位键等待系统重启。

3. 如何恢复到出厂？

使用取卡针，长按6秒复位键直到界面显示LOGO后松开，在30秒内再次长按复位键6秒，等待系统重启即表示已恢复到出厂设置。

注意事项

- 安装位置注意避免靠近大面积金属物体，以免信号干扰影响使用。
- 不能在潮湿环境中使用，禁止灼烧，远离热源。
- 请勿打开、改动、修理或维护本产品，否则不予保修。

* 本说明书的内容如有变更，恕不另行通知。若内容与您使用的功能有所不同，则以实物为准。如有疑问，欢迎向我司授权的经销商咨询。

保修条例

- 自出厂之日起保修服务期为2年。
- 在保修服务期内出现产品质量问题雷特科技将给予免费修理或更换服务。

非保修条例：

属下列情况不在免费保修或更换服务范围之内：

- 已经超出保修期限的；
- 过高电压、超负载、操作不当等人为造成的损坏；
- 产品外形严重损坏或变形；
- 自然灾害以及人力不可抗拒原因造成的损坏；
- 产品保修标签和产品唯一条形码损坏；
- 无雷特科技签订的合同或发票凭证。

1. 修理或更换是雷特科技对客户唯一补救措施。雷特科技不承担任何附带引起的损害赔偿，除非在适用法律范围之内。

2. 雷特科技享有修正或调整本保修条款的权利，并以书面形式发布为准。



咪咕音乐提供的音乐服务将随运营规则调整而变化。