

# LTECH

## Color Temperature Knob Panel

Model: E6A



Manual

[www.ltech-led.com](http://www.ltech-led.com)

# Product Introduction

- The stylish appearance design is combined with innovative and colorful status indicators, making the interaction of technology clear at a glance;
- 0-10V Analog + Bluetooth dual-mode knob controller, standard 0-10V dimming, Bluetooth SIG Mesh protocol;
- Supports switching between dimming and color temperature;
- Scene actions can be set through NFC or L-Home APP;
- It can be used with Bluetooth remote controls B1, B2, B8 and RC4-BLE control;
- Supports linkage control with L-Home smart home system and APP to realize intelligent control such as local scenes, automation and other intelligent controls;
- With the intelligent gateway, you can realize the linkage control of smart platforms such as HomeKit, Siri, Google, Amazon.

## Specification Parameters

Model	E6A
Output Signal	0-10V
Rated Parameters	100-240V~, 50/60Hz
Control Type	DIM, CT
Wireless Type	Bluetooth 5.0 SIG Mesh
Compatible remote control	B1、B2、B8、RC4-BLE
Compatible Driver	0-10V dimming, color temperature drive
Compatible APP	L-Home、NFC Lighting
Working Temperature	-25°C~50°C
Dimensions	86×86×52mm (L×W×H)
Package Size	102×102×73mm (L×W×H)
Product Weight	130g

# Product Size

Unit: mm

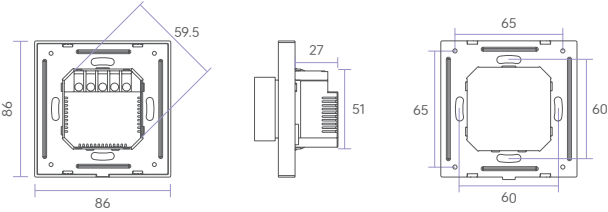

# Product Function Description

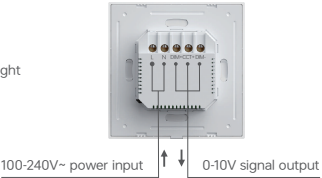
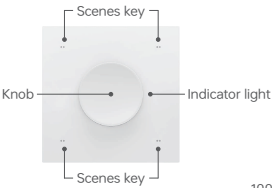

**Scenes key:** Factory default color temperature mode: the default lamp color temperatures are 2700K (Key 1), 3500K (Key 2), 5000K (Key 3), and 6500K (Key 4); Single press key 1/2/3/4 of the scene key triggers the scene, which requires binding the scene actions via L-Home APP Bluetooth wireless or NFC Lighting APP NFC.

**Knob:** Supports single click, double click, long press and rotation; supports setting three levels of sensitivity adjustment: high, medium and low.

**Indicator light:** The corresponding color is displayed according to the current adjustment value of the knob: white (BRT) and yellow (CT). The factory default color is white.

**Restore to factory settings:** Press and hold the knob for 15 seconds until the indicator light flashes slowly, then release it. Within 3 seconds, press the knob 3 times briefly, and the indicator light will flash quickly.

### Introduction to the use of the knob:



Single Press



Double Press



Rotate



Long Press

Note: Different operations are available depending on the configuration type of the knob.

Device \ Action	Single Press	Double Press	Rotate	Long Press
DIM light	ON/OFF	No action	Adjust BRT	Adjust BRT
CT light	ON/OFF	Switch mode: BRT/CT	Adjust current BRT/CT	Adjust BRT

# Installation Steps

① Turn off the main power switch, and confirm that there are no attachments such as cement on the inner wall of the 86 junction box. Trim the length of the power cord inside the junction box to about 10 cm. Use a flat-blade screwdriver to pry open the bottom box of the knob panel, and find the NFC marking point on the plastic part.



② Use your mobile phone to open the NFC Lighting APP, click [Read/Write Smart Device] on the "Home Page", bring the mobile phone sensing area close to the knob panel NFC identification point, read the knob panel parameters, set the parameters according to your needs (see P8 for details), click [Write] in the upper right corner, and then bring the mobile phone sensing area close to the knob panel NFC identification point, and you can directly write to the knob panel.



③ See Figure 1, after using the mobile phone's NFC to read and write parameters, connect the live wire to the L interface of the smart switch, and the neutral wire to the N interface, and confirm that the power cable is in good contact with the switch binding post and there is no exposed copper wire. (The circuit breaker rating should not exceed 35A)

See Figure 2, fix the bottom box to the wall secret box with screws, so that the bottom box fits the wall.

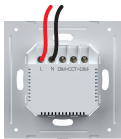
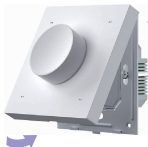

Figure 1



Figure 2

④ Tilt the panel and buckle it on the bottom box, turn on the power main gate, press the knob panel, and you can control the light normally, which means that the installation is correct.



Step 1: Buckle down

Step 2: Buckle the bottom

# Connection diagram

① Wiring method for single E6A to control multiple drivers.

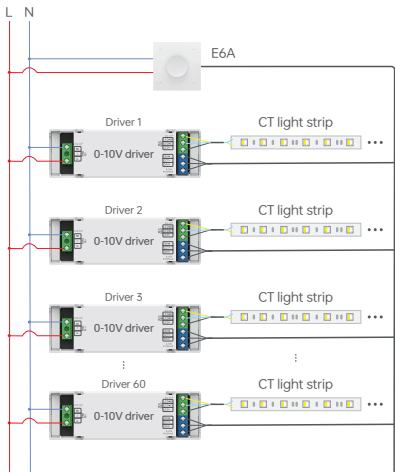

② 0-10V Bluetooth wireless connection method.

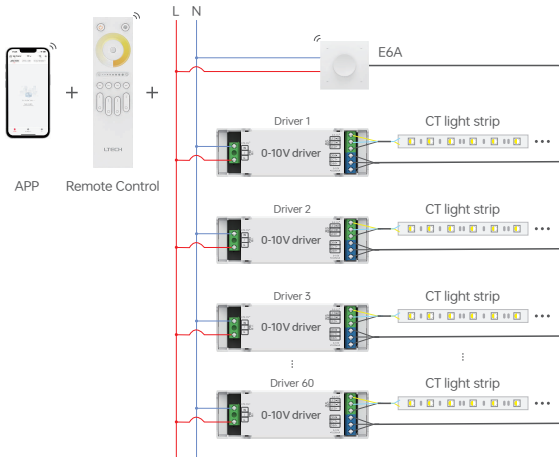

\*Please try to avoid wireless drivers being placed next to large areas of metal objects or in spaces with more metal media to avoid interference from being used.



# Use with NFC Lighting APP

## 1. Register an account

Scan and download the QR code through your mobile phone, and follow the prompts to complete the APP installation and log in/register. (Due to performance requirements, the phone model is required for Apple: iPhone 8 and above, and operating system iOS 13 and above; Android: NFC-functional model)



\* When setting the device parameters, the operation must be performed when the device is powered off.

## 2. Read/write knob panel

Click [Read/Write Smart Device] on the "Homepage" of the APP, and bring the phone's sensing area close to the NFC marking point of the knob panel (Figure P4) to read the knob panel parameters.



### 3.How to set control type and parameters

**Control type:** Click "Control type" to select DIM/CT, default CT.

**Parameters:** Click "Parameter" to edit the knob sensitivity, indicator light, key press sound, scene key, powered on state and other advanced parameters.

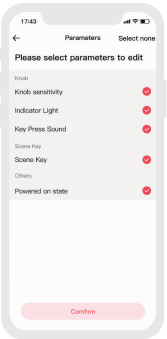
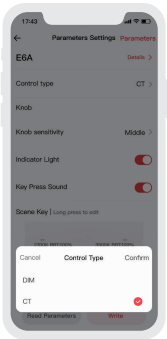
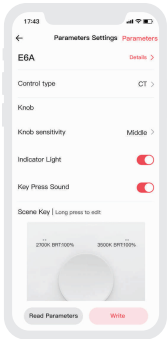

## 4.How to set knobs and scene keys

**Knob:** Click "Knob Sensitivity" to select low/medium/high sensitivity; turn on/off indicator light, turn on by default; turn on/off key press sound, turn on by default.

**Scene key:** Press and hold the scene key to bind to execute actions.

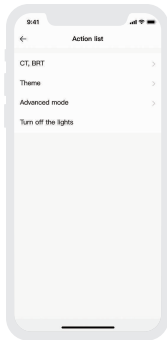
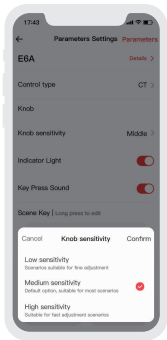
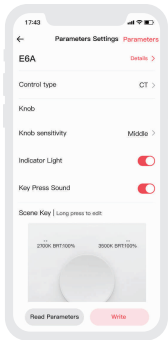

## 5.Power-on status and factory reset settings

**Power-on status:** You can choose to full bright/light is off/memorize/custom, default memorize.

**Restore factory:** After clicking the "All parameters are restored to factory default" button, all parameters on the APP page will be restored to factory default value. At this time, you need to click the "Write" button to write the parameters to the device to restore the device to factory settings.

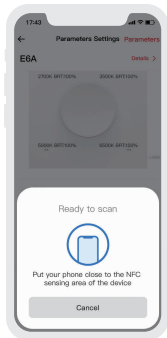
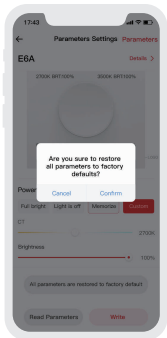
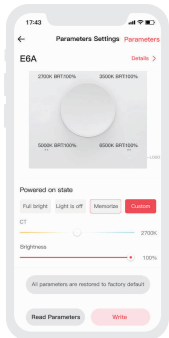

# For Use With The L - Home APP.

## 1. Register an account

Scan the QR code below with your mobile phone. After completing the APP installation according to the prompts, you can proceed with the login/registration operation.



## 2. Pairing operation

For new users, after creating a home on the APP, click the "+" icon in the upper right corner on the [Room] interface for addition. Select "LED Controller" from the device addition list, and follow the prompts on the installation interface to complete the addition.

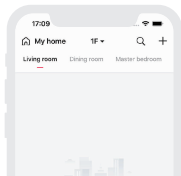

### 3.How to set knobs and scene keys

Click the added knob panel in the "room" interface to enter the [Control] interface.

**Knob:** Support clicking the knob to enter the page to adjust the light.

**Scene key:** Each key supports binding different execution actions.

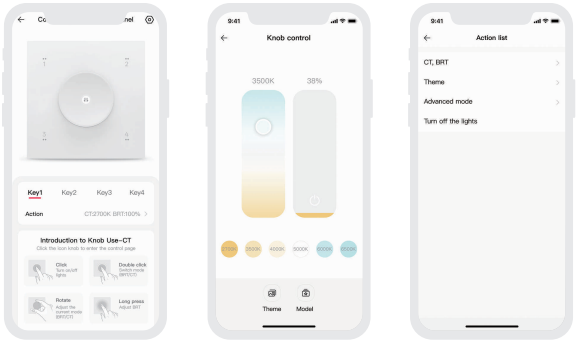

#### 4. Bound by remote control

The knob panel can be bound to the B1/B2/B8/RC4-BLE remote control as a lamp;  
Each partition of the remote control supports binding a knob panel;  
After binding, the remote control area controls the load on the knob panel.

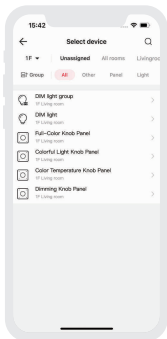
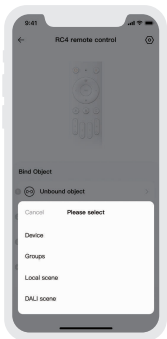
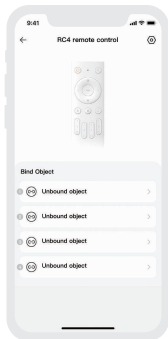

## 5. How to set scenes and automation

**Local scene:** Select "Local scene" in the [Smart] interface and click "+" to create a local scene. Click Add Action and select the corresponding device type action.

**Cloud scenario:** Make sure that smart gateways have been added to the home, such as Super Panel 12S.

Select "Cloud Scene" in the [Smart] interface and click "+" to create a cloud scene. Click Add Action and select the corresponding device type action.

**Automation:** Ensure that smart gateways have been added to the home, such as the Super Panel 12S.

Select "Automation" in the [Smart] interface and click "+" to create automation. You can choose local/cloud execution method, as well as set trigger conditions and execute actions. When the set trigger conditions are met, a series of device actions are automatically triggered to achieve remote linkage.

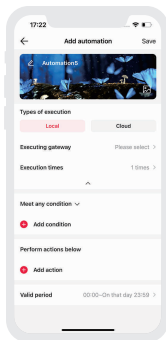
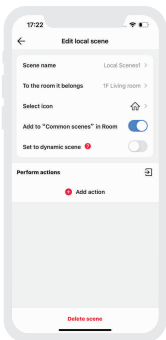
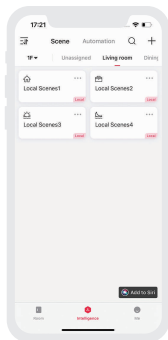



# Restore To Factory Settings

**Method 1:** After the E6A knob panel is connected to power, press the knob for 15 seconds (see Figure 1) until the indicator light flashes slowly and then releases. Press the knob for a short time 3 times within 3 seconds, and the indicator light flashes quickly, indicating that it has returned to the factory settings.

**Method 2:** First, make sure that the device is properly powered on and in an online state. Then, open the L - Home APP, find the device, and enter its settings page. Click the "Delete Device" button (see Figure 2). When the system prompts "Deletion successful", it means that the device has been successfully restored to its factory settings.



Figure 1

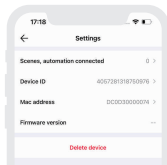

Figure 2

## FAQs

### 1. What to do if the network configuration fails?

- ① Ensure that the device is powered on normally.
- ② Confirm that the device being added has not been added by another account. If it has been added, please manually restore the factory settings.
- ③ Ensure that the mobile phone and the device are as close as possible, preferably within 15 meters.
- ④ If the device has been forcibly deleted, please manually restore the factory settings and then add the device again.

### 2. How to remotely control the device?

When paired with our company's Smart gateway, the device can be remotely controlled via 4G/5G/WiFi on a mobile phone.

# Attentions

- Product installation and commissioning should be done by a qualified professional.
- LTECH products are and not lightningproof non-waterproof (special models excepted). Please avoid the sun and rain. When installed outdoors, please ensure they are mounted in a water proof enclosure or in an area equipped with lightning protection devices .
- Good heat dissipation will prolong the working life of products. Please ensure good ventilation.
- Please check if the working voltage used complies with the parameter requirements of products.
- The diameter of wire used must be able to load the light fixtures you connect and ensure the firm wiring.
- Before you power on products, please make sure all the wiring is correct.
- If a fault occurs, please do not attempt to fix products by yourself. If you have any question, please contact your suppliers.

# Warranty Agreement

- Warranty periods from the date of manufacture: 5 years.
  - Free repair or replacement services for quality problems are provided within warranty periods.
- Warranty exclusions below:
- Following conditions are not within the guarantee range of free repairing or replacement services:
- Beyond warranty periods.
  - Any artificial damage caused by high voltage, overload, or improper operations.
  - Products with severe physical damage.
  - Damage caused by natural disasters and force majeure.
  - Warranty labels and barcodes have been damaged.
  - No any contract or invoice signed by LTECH .
1. Repair or replacement provided is the only remedy for customers. LTECH is not liable for any incidental or consequential damage unless it is within the law .
  2. LTECH has the right to amend or adjust the terms of this warranty. The warranty that issues in writting shall prevail.
- \* This manual is subject to changes without further notice. Product functions depend on the goods. Please feel free to contact our official distributors if you have any question.