

# LTECH

## Push to DALI Module

Model: KPD



### Manual

[www.ltech-led.com](http://www.ltech-led.com)

# Product Introduction

- Make the ordinary switch into DALI master control, support 4-way reset switch or 4-way mechanical switch input control DALI device;
- The corresponding DALI instruction type can be set freely through the mobile APP NFC;
- Support massive DALI instruction type Settings: such as switch, dimming, color, brightness value, color temperature value, color value, scene and other instruction types;
- Supports broadcast, single address, group address, and scene Settings;
- Supported device types: DT6, Tc, XY coordinates, RGBWAF;
- Each reset switch supports short press, long press, double click three operations, each operation can set up to 10 instruction cycles;
- Each mechanical switch supports on and off operations, each operation can be set corresponding instructions;
- Small size, convenient installation; Can be placed national standard, European regulations, American regulations and other wiring cassette installation.

## Technical Specs

Model	KPD
Current consumption	≤2mA@16V
Power supply mode	DALI Bus power supply
Input signal	Dry contact
Output signal	DALI
Working environment	-25°C~50°C
Product size	L45×W20.5×H45.5(mm)
Package size	L50×W28×H50(mm)
Product weight	30g

CE RoHS



## Product icon

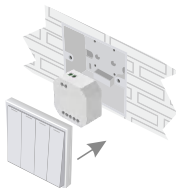
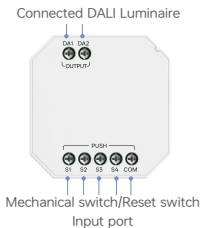

Hide the product in the switch bottom box

## Product size

Unit: mm

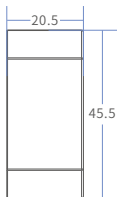
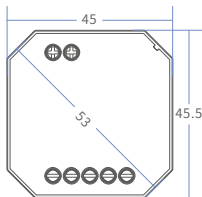

1. Connect four pcs one-way reset switches

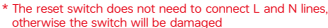

## 2. Connect a one-way reset switch and a three-way reset switch

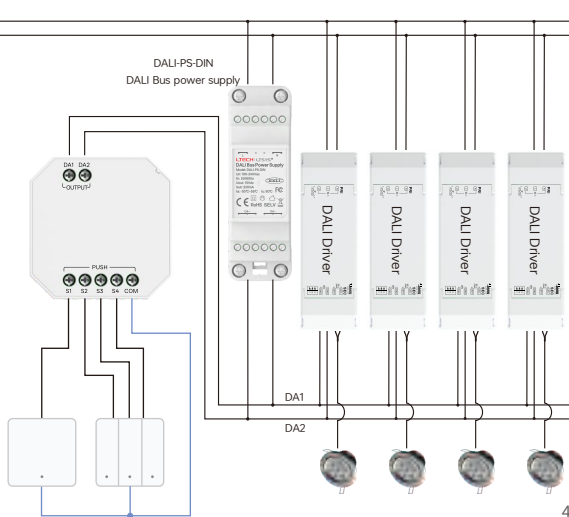



#### 4. Connect a four-way reset switch

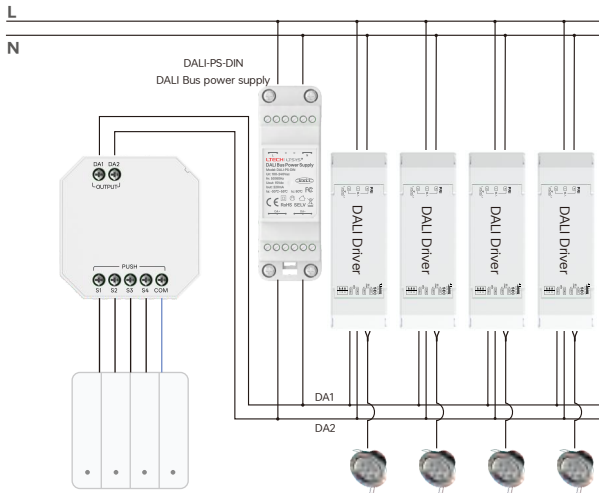

## 5. Get a four-way mechanical switch (Mechanical switches with one and multiple connections)

L

N

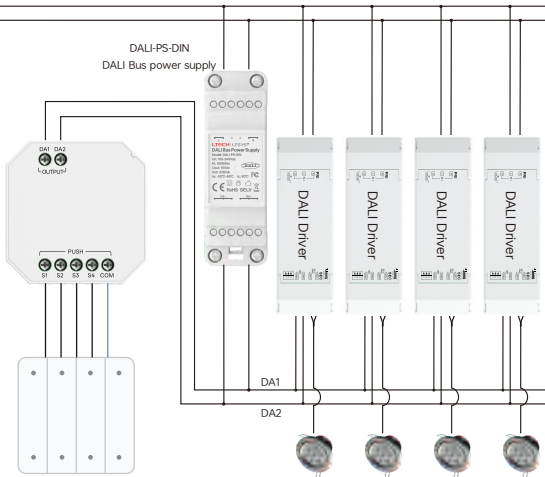

\*The mechanical switch does not need to be connected to L and N lines,  
otherwise the switch will be damaged



# Use the NFC Lighting APP

Scan the QR code below with your mobile phone and install the APP as prompted.

(Due to performance requirements, the required phone model is Apple: iPhone8 or above, and the operating system iOS13 or above; Android: NFC enabled models)



Scan code download APP  
ios/apk



NFC identifier of the device

**\*When setting device parameters,  
Perform this operation only when  
the device is powered off.**

## 1. Read the device

Click "Read/Write smart Power Supply" in the APP [home page], place the sensing area of the phone near the NFC identification point of the driver, and read the device parameters.

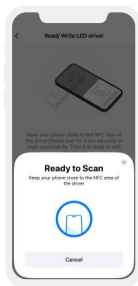
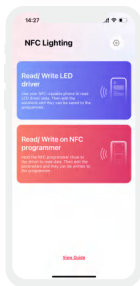

## 2. Edit parameters

Click "Parameter Management" to select parameters such as edit control object, switch type and switch action.

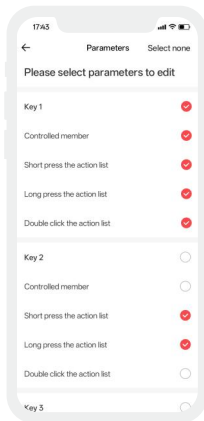
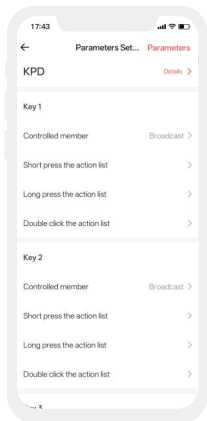

### 3. Select the control object of the key

Click Control Object to set DALI address information corresponding to each control object, including single address, group address, or broadcast address.

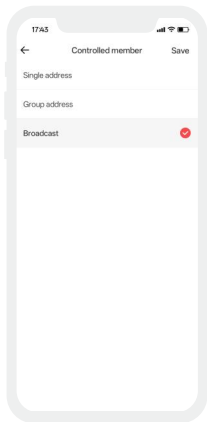
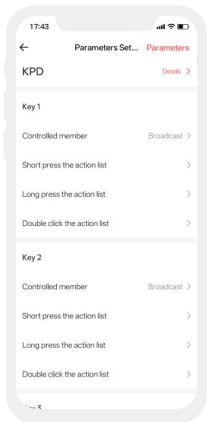

## 4. Select the action list of the key

- ① When the reset switch is selected, the short-press or long-press action list can bind a maximum of 10 instructions, and the double-click operation can bind a maximum of 4 instructions. The binding actions will be executed in a loop according to the setting sequence.
- ② When the switch is selected as a mechanical switch, each command supports only the on-off action and the off action, and each action can be bound to 1 command.

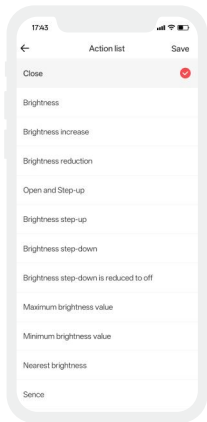
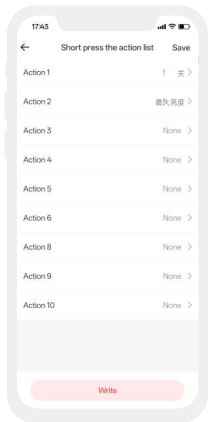

## Attention

- Product installation and commissioning should be done by a qualified professional;
- LTECH products are and not lightningproof non-waterproof (special models excepted). Please avoid the sun and rain. When installed outdoors, please ensure they are mounted in a water proof enclosure or in an area equipped with lightning protection devices;
- Good heat dissipation will prolong the working life of products. Please ensure good ventilation.
- Please check if the working voltage used complies with the parameter requirements of products;
- Before you power on products, please make sure all the wiring is correct in case of incorrect connection that causes damage to light fixtures.;
- If a fault occurs, please do not attempt to fix products by yourself. If you have any question, please contact your suppliers.

\* This manual is subject to changes without further notice. Product functions depend on the goods.  
Please feel free to contact our official distributors if you have any question.

# Warranty Agreement

- Warranty periods from the date of delivery : 2 years.
- Free repair or replacement services for quality problems are provided within warranty periods.

Warranty exclusions below:

Following conditions are not within the guarantee range of free repairing or replacement services:

- Beyond warranty periods;
  - Any artificial damage caused by high voltage, overload, or improper operations;
  - Products with severe physical damage;
  - Damage caused by natural disasters and force majeure;
  - Warranty labels and barcodes have been damaged;
  - No any contract signed by LTECH.
1. Repair or replacement provided is the only remedy for customers. LTECH is not liable for any incidental or consequential damage unless it is within the law.
  2. LTECH has the right to amend or adjust the terms of this warranty. The warranty that issues in writing shall prevail.

