

Intelligent LED Driver(Constant Current)

- Housing made from SAMSUNG/COVESTRO's V0 flame retardant PC materials;
- Ultra small, thin and lightweight, screwless end cap;
- Matter over Thread certified devices require use with a Matter hub that supports Thread border router functionality;
- Supports control via major smart home platforms, including Apple Home, Google Home, Amazon Alexa, SmartThings, and more;
- Supports voice control, including Apple Siri, Google Assistant, Amazon Alexa, Samsung Bixby, and more;
- Easily debug and pair by scanning the QR code;
- Supports OTA updates via the Matter standard;
- Supports NFC quick programming, allowing you to use a mobile app to adjust output current, on/off dimming transition time, brightness range, and other parameters via NFC.
- Current step values as low as 1mA, offering enhanced compatibility and finer control;
- Dimming from 0~100%, down to 0.0001%.
- Features a soft start gradual brightening function for enhanced visual comfort;
- Comply with the EU's ErP Directive, networked standby<0.5W;
- Overheat, over voltage, overload, short circuit protection and automatic recovery;
- Suitable for Class I/II/III indoor light fixtures;
- Normal service life can reach 100,000 hours;
- 5-year warranty (Rubycon capacitor).

DIM  
Flicker Free  
IEEE 1789  
T-PWM  
Dimming Technology

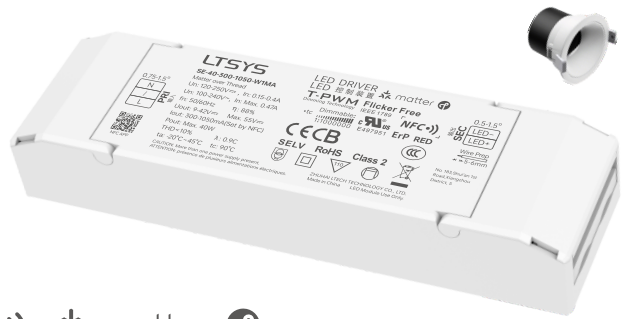

Dimmable: 1:1000000  
NFC  
Matter

CE CB CCC E497951 ErP RED Class 2 SELV RoHS

NFC Multi current setting  
Overheat Protection  
Over voltage protection  
Over Load protection  
Short circuit protection

Technical Specs

Model	SE-40-300-1050-W1MA	SE-30-200-800-W1MA	
FEATURES	Output Type	Constant current	
	Dimming Interface	Matter over Thread	
	Output Feature	Isolation	
	IP Rating	IP20	
	Insulation Class	Class II (Suitable for class I/II/III light fixtures)	
OUTPUT	Output Voltage	9-42V	
	Max. Output Voltage	≤55V	
	Rated Current Range	300-1050mA (Set higher current levels via the mobile app's NFC feature, with step increments as low as 1mA; Default: 300mA)	200-800mA (Set higher current levels via the mobile app's NFC feature, with step increments as low as 1mA; Default: 800mA)
	Load Power Range	2.7W~40W	1.8W~30W
	Dimming Range	0~100%, Dimming depth: 0.0001% (Set additional gear ratios via the mobile app's NFC feature, Default: 0.01%)	
	LF Current Ripple	<3% (Maximum current for non dimming state)	
	Current Accuracy	±5%	
	PWM Frequency	≤3600Hz	
INPUT	DC Voltage Range	120-250V	
	AC Voltage Range	100-240V~	
	EoF <sub>i</sub>	EoF <sub>i</sub> =100%	
	Rated Voltage	115V~/230V~	
	Frequency	0/50/60Hz	
	Input Current	≤0.45A/115V~, ≤0.22A/230V~	≤0.34A/115V~, ≤0.17A/230V~
	Power Factor	PF>0.95/115V~ (Fully loaded), PF>0.9C/230V~ (Fully loaded)	
	THD	THD≤10%/230V~ (Fully loaded)	
	Efficiency(Typ.)	88%@950mA (Fully loaded)	87%@750mA (Fully loaded)
	Inrush Current	Cold start 25A (Test twidth=130us tested under 50% Ipeak)/230V~	
	Anti Surge	L-N: 2KV	
Leakage Current	Max. 0.5mA		
ENVIRONMENT	Operating Temperature	ta: -20 ~ 45°C tc: 90°C	
	Working Humidity	20 ~ 95%RH, non-condensing	
	Storage Temperature/Humidity	-40 ~ 80°C/10~95%RH	
	Temperature Coefficient	±0.03%/°C(-20-45°C)	
	Vibration	10~500Hz, 2G 12min/1cycle, 72 min for X, Y and Z axes respectively	
PROTECTION	Overload Protection	Automatically protect the device when the load exceeds 102% of the rated power. Automatically recover once load is reduced	
	Overheat Protection	Intelligently adjust or turn off the current output if the PCB temperature ≥110°C. When the PCB temperature <90°C, automatically recover normal output	
	Overvoltage Protection	Automatically protect the device when voltage exceeds the no-load voltage. It can be recovered automatically	
	Short Circuit Protection	Enter hiccup mode if short circuit occurs, and recover automatically	
SAFETY & EMC	Withstand Voltage	I/P-O/P: 3750V~	
	Insulation Resistance	I/P-O/P: 100MΩ/500VDC/25°C/70%RH	
	Safety Certifications	CCC China	GB19510.1, GB19510.14, GB19510.213
		CB CB Member States	IEC61347-1, IEC61347-2-13
		CE European Union	EN61347-1, EN61347-2-13, EN62384
		CUL Canada	CSA C22.2 No.250.13
		UL United States	UL 8750
	EMC Emission	CCC China	GB/T17743, GB17625.1
		CE European Union	EN55015, EN61000-3-2, EN61000-3-3, EN61547
		CUL Canada	ICES-005
UL United States		FCC part 15B	
EMC Immunity	EN61000-4-2,3,4,5,6,8,11, EN61547		
ErP	Power Consumption	Networked standby < 0.5W (After shutdown by command) No-load power consumption < 0.5W (When the lamp is not connected)	
	Flicker/Stroboscopic Effect	IEEE 1789 CIE SVM Meet IEEE 1789 standard/High frequency exemption level	
	DF	Phase factor DF≥0.9	
	Weight(N.W.)	170g±10g	150g±10g
OTHERS	Dimensions	142×40×23mm(L×W×H)	

Typical Current Corresponding Parameter Table

The following 16 groups of typical current data are provided for model selection reference. More currents can be set via the mobile phone APP NFC. The settable range is 300-1050mA, and the current step value can be as low as 1mA.

SE-40-300-1050-W1MA	Output Current	300mA	350mA	400mA	450mA	500mA	550mA	600mA	650mA
	Output Voltage	9-42Vdc	9-42Vdc	9-42Vdc	9-42Vdc	9-42Vdc	9-42Vdc	9-42Vdc	9-42Vdc
	Output Power	2.7-12.6W	3.15-14.7W	3.6-16.8W	4.05-18.9W	4.5-21W	4.95-23.1W	5.4-25.2W	5.85-27.3W
	Output Current	700mA	750mA	800mA	850mA	900mA	950mA	1000mA	1050mA
	Output Voltage	9-42Vdc	9-42Vdc	9-42Vdc	9-42Vdc	9-42Vdc	9-42Vdc	9-40Vdc	9-38Vdc
	Output Power	6.3-29.4W	6.75-31.5W	7.2-33.6W	7.65-35.7W	8.1-37.8W	8.54-39.9W	9-40W	9.45-40W

The following 13 groups of typical current data are provided for model selection reference. More currents can be set via the mobile phone APP NFC. The settable range is 200-800mA, and the current step value can be as low as 1mA.

SE-30-200-800-W1MA	Output Current	200mA	250mA	300mA	350mA	400mA	450mA	500mA	550mA
	Output Voltage	9-42Vdc	9-42Vdc	9-42Vdc	9-42Vdc	9-42Vdc	9-42Vdc	9-42Vdc	9-42Vdc
	Output Power	1.8-8.4W	2.25-10.5W	2.7-12.6W	3.15-14.7W	3.6-16.8W	4.05-18.9W	4.5-21W	4.95-23.1W
	Output Current	600mA	650mA	700mA	750mA	800mA	/	/	/
	Output Voltage	9-42Vdc	9-42Vdc	9-42Vdc	9-40Vdc	9-37.5Vdc	/	/	/
	Output Power	5.4-25.2W	5.85-27.3W	6.3-29.4W	6.75-30W	7.2-30W	/	/	/

Product Size

Unit: mm

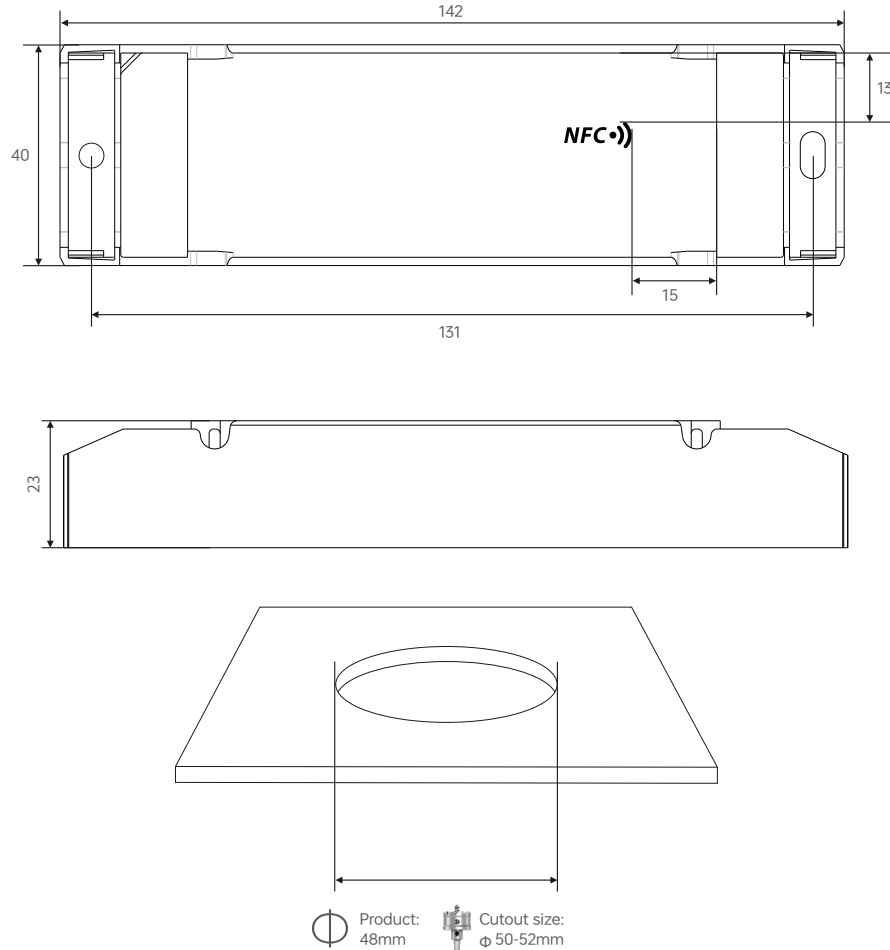

## Connectivity Diagram

### Wireless Connection Methods

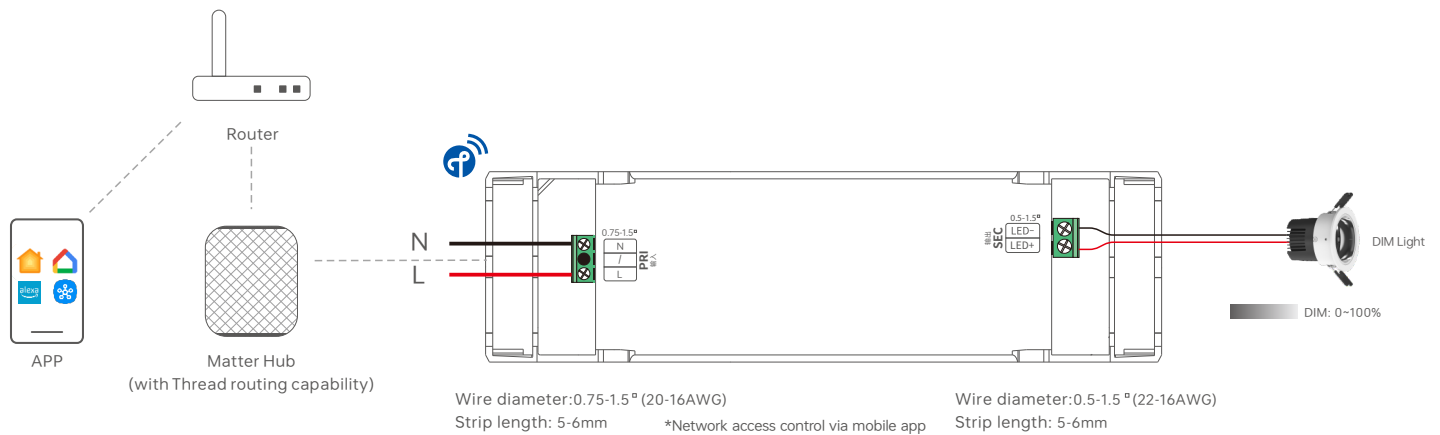

## Application Diagram of Protective Cover

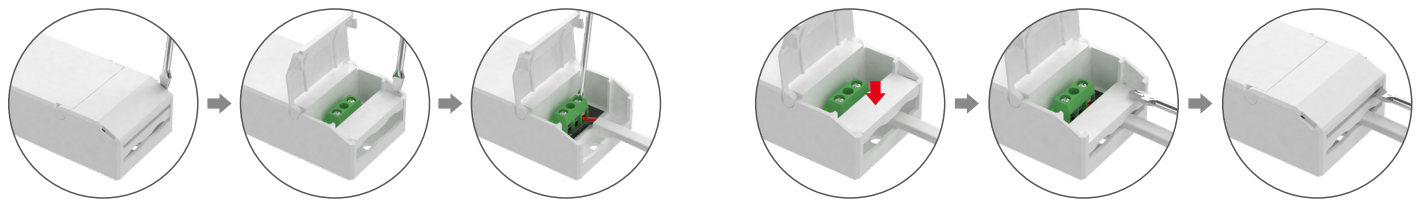

1. Put the head of a screwdriver on the side of the housing to pry up both the protective cover and wire fixing board. Then remove the wire fixing board and connect to the wires as wiring diagram shows.

2. Install the wire fixing board and press it down. Then snap on the protective cover while pressing the wire fixing board with a small flat-head screwdriver

## Installation Precautions

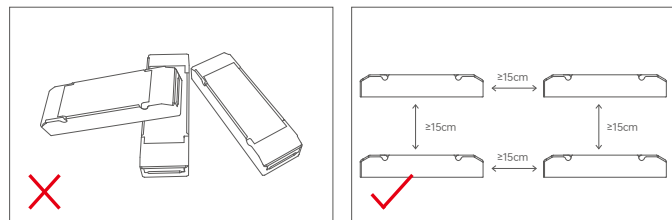

Please do not stack the products. The distance between two products should be  $\geq 15\text{cm}$  so as not to affect heat dissipation and the lifespan of the products.

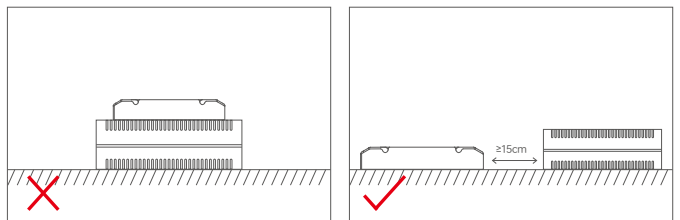

Please do not place the products on the floor. The distance between the product and the floor should be  $\geq 100\text{cm}$  so as to avoid signal interference.

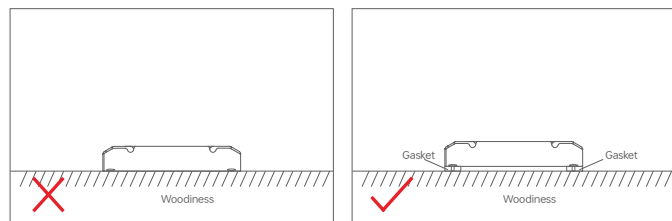

Do not fix the product tightly against the wooden board with screws. Please add a washer  $\geq 7\text{mm}$  thick under the mounting screws to leave a gap for effective heat dissipation, so as to avoid affecting the heat dissipation and service life of the product.

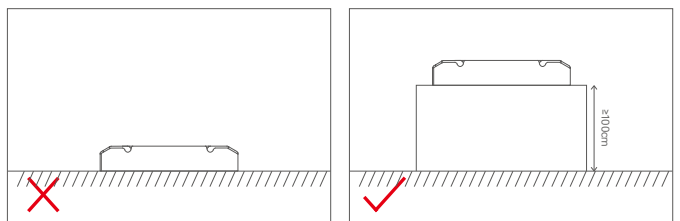

Please do not place the products on the floor. The distance between the product and the floor should be  $\geq 100\text{cm}$  so as to avoid signal interference.

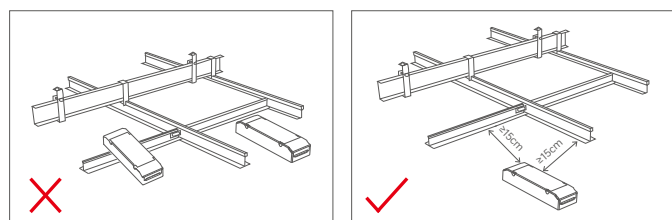

Do not allow the product to come into large-area contact with metal objects (e.g. keel frames). The separation distance shall be  $\geq 15\text{cm}$  to avoid signal interference affecting operation.

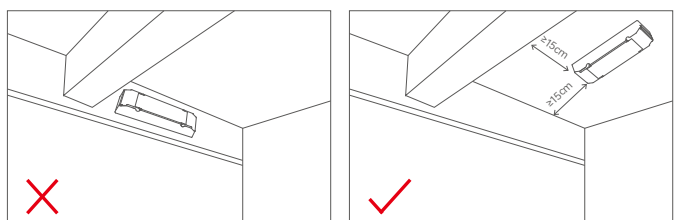

Please do not install the products on beams or near the corners. The distance between the product and the beam or the corner should be  $\geq 15\text{cm}$  so as to avoid signal interference.

Relationship Diagrams

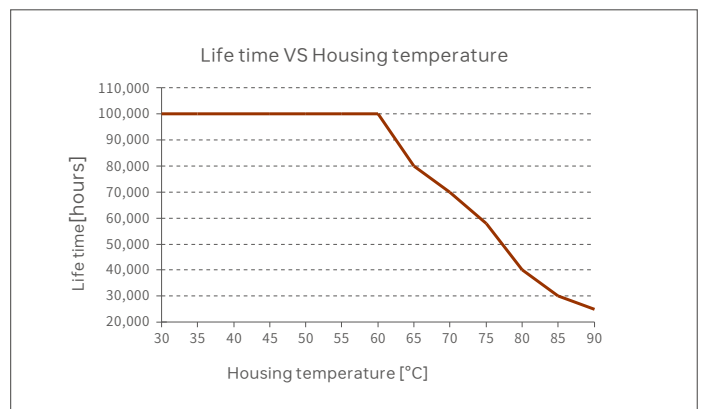
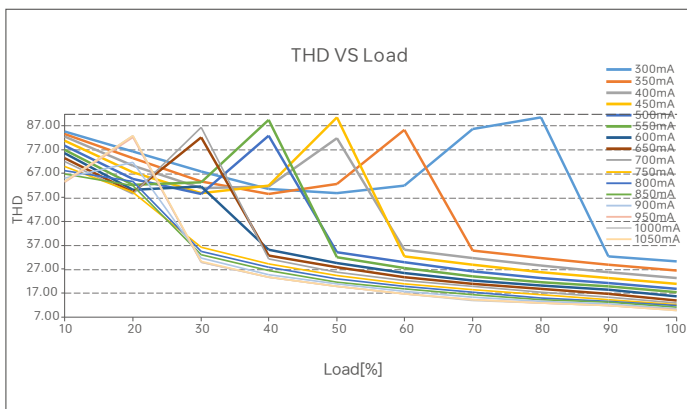
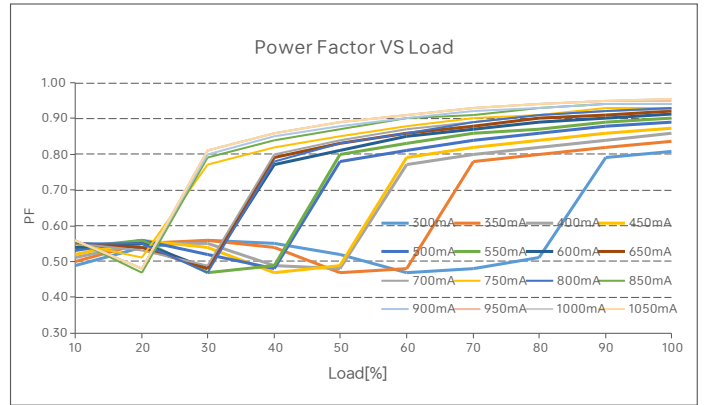
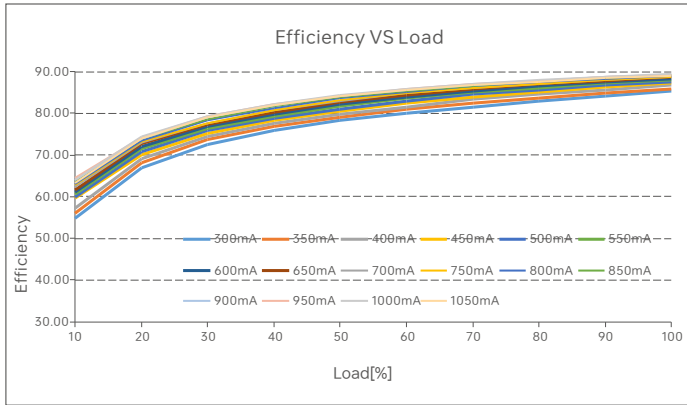

SE-40-300-1050-W1MA

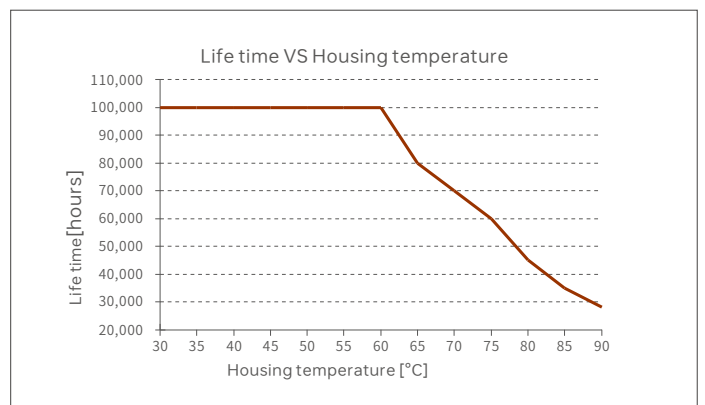
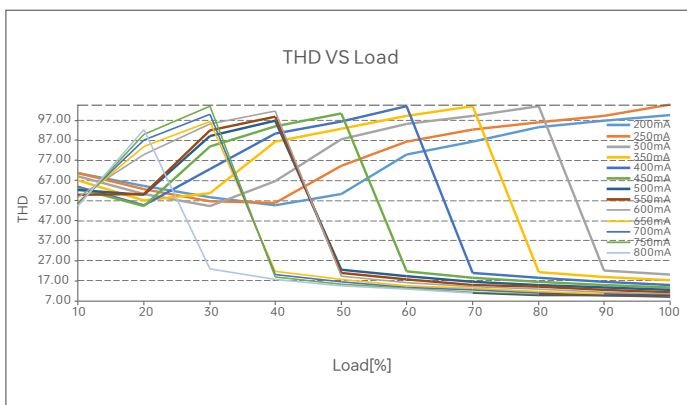
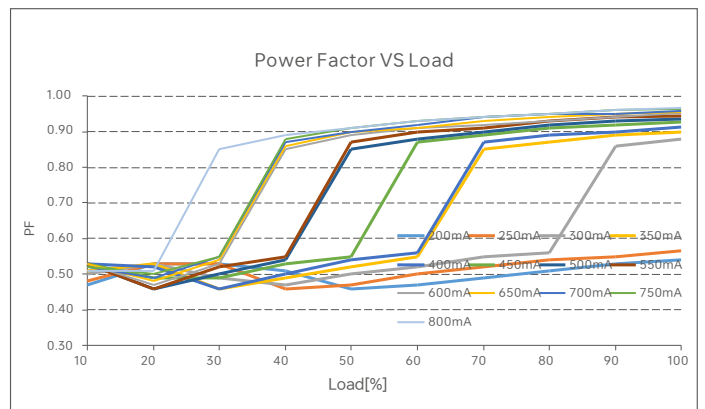
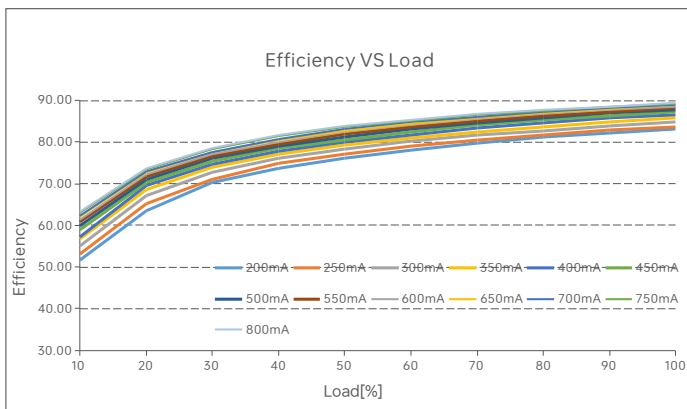

SE-30-200-800-W1MA

Surge Current & Corresponding Miniature Circuit Breaker (MCB) Load Capacity Table

MCB Model	B10	B13	B16	B20	B25	C10	C13	C16	C20	C25	D10	D13	D16	D20	D25
Maximum Load Capacity	15	19	24	30	40	17	22	27	35	43	20	25	31	39	49

Remarks:

1. Test Conditions: Cold start 25A(Test twidth=130us tested under 50% Ipeak)/230V~ .
2. The number of supported drivers may vary depending on the brand and model of the MCB.
- 3.It is recommended not to exceed the specified load capacity during on-site installation. The actual load should be determined based on field conditions.
- 4.If the ambient temperature exceeds 30°C or multiple MCBs are installed side by side, the number of installed drivers must be reduced and recalculated accordingly.
- 5.Electricians typically use Type B MCBs for residential lighting and Type C MCBs for commercial lighting applications.
- 6.Different testing equipment may yield variations in measured current peaks and pulse widths. Always use professional-grade instruments for accurate testing.

Flicker Test Sheet

IEEE 1789

Limit of modulation in low risk area	
Waveform frequency of optical output	limit (%)
$f \leq 8\text{Hz}$	0.2
$8\text{Hz} < f \leq 90\text{Hz}$	$0.025 \times f$
$90\text{Hz} < f \leq 1250\text{Hz}$	$0.08 \times f$
$f > 1250\text{Hz}$	Exemption assessment
Limit of modulation in no effect area	
Waveform frequency of optical output	limit (%)
$f \leq 10\text{Hz}$	0.1
$10\text{Hz} < f \leq 90\text{Hz}$	$0.01 \times f$
$90\text{Hz} < f \leq 3125\text{Hz}$	$(0.08/2.5) \times f$
$f > 3125\text{Hz}$	Exemption assessment (High frequency exemption)

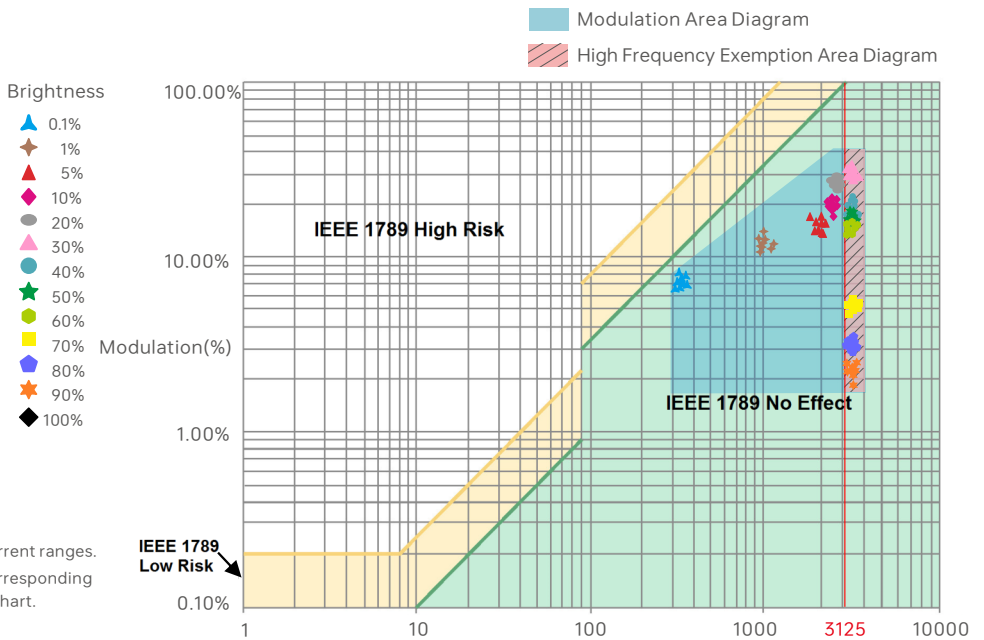

Marks in the right chart were tested results of different current ranges. The output frequency is 0Hz in 100% brightness and its corresponding modulation is 0%, which could not be shown in the right chart.

Add to Matter Platform Instructions

1. This device supports control via major smart home platforms, including Apple Home, Amazon Alexa, Google Home, SmartThings, and others.
2. To connect Matter over Thread devices, you need a Matter hub supporting Thread border router functionality from major platforms. Refer to the image below for compatible models.

Apple Home	Google Home	Amazon Alexa	SmartThings
Apple HomePod (second-gen)	Google Nest Hub (2nd Gen)	Amazon Echo (4th-gen)	Aeotec SmartThings Smart Home Hub
Apple HomePod Mini	Google Nest Hub Max	Amazon Echo Hub	Samsung SmartThings Station
Apple TV 4K (2nd gen)	Google Nest Wifi Pro	Amazon Echo Show 8 (3rd-gen)	Samsung SmartThings Hub Dongle
Apple TV 4K (3rd gen,128 GB)	Google TV Streamer (4K)	Amazon Eero 6, Pro 6, 6 Plus, Max 7 etc.	Samsung SmartThings Hub v3

3. This guide uses Apple Home as an example. First, prepare an iPhone (iOS 16.2 or later) or iPad (iPadOS 16.2 or later) with the latest firmware, along with an Apple HomePod mini also running the latest firmware. Then connect your iPhone or iPad to your home Wi-Fi network, launch the Apple Home app, and follow Apple's instructions to set up the HomePod mini.

\*For iPhone models 16 and above, no Matter hub is required; devices can be added directly.

Matter System Diagram

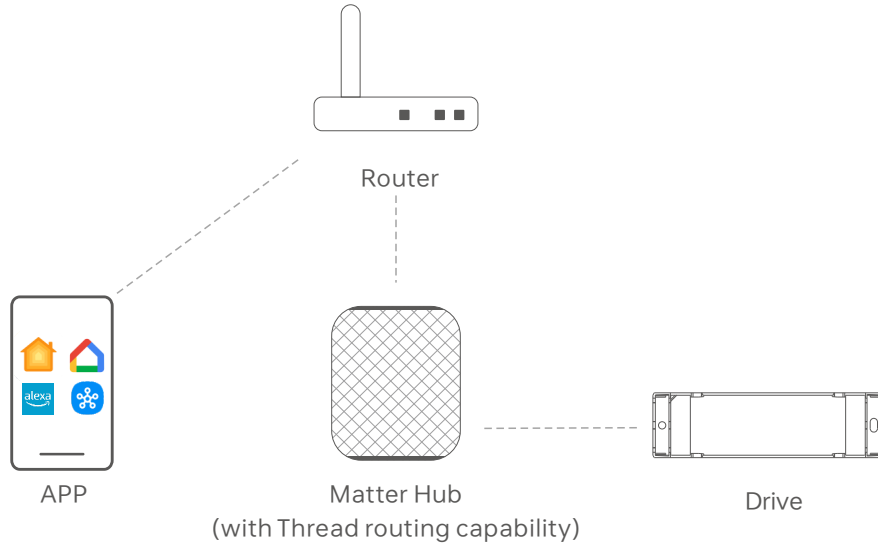

Add Steps

1. Add accessories

Open the Apple Home app and tap “Add or Scan Accessories.” Add the device to the Home app by scanning the QR code sticker on the device, as shown below.

\*Alternatively, you can add it via NFC: Open the Home app and hold it near the device’s NFC sensor area to add it.

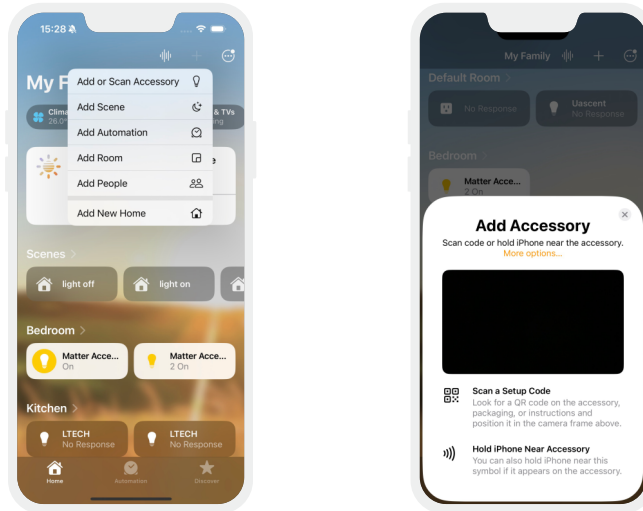

2. Control device

After successfully adding a device, click the device icon to turn it on or off; click the device card to enter the brightness control interface.

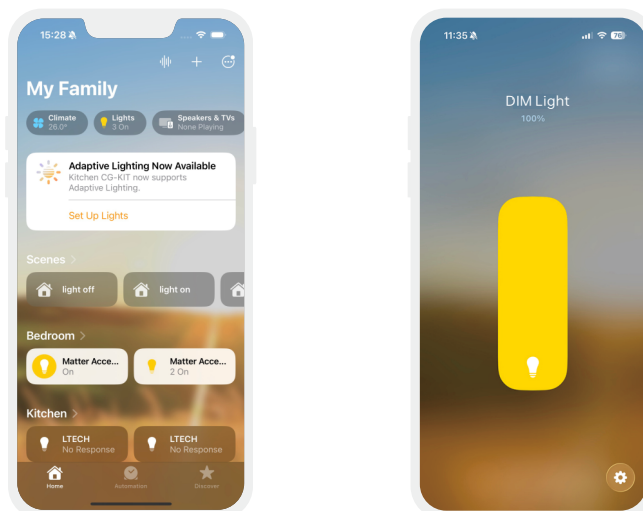

### 3. Advanced Features

Supports creating groups, scenes, and automations, enabling remote control and scheduled control. Devices can also be controlled via Siri voice commands.

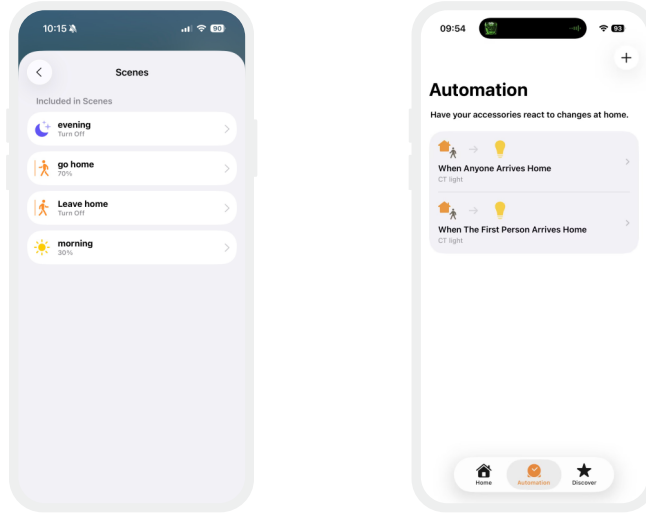

### 4. Multi-Ecological Distribution Network

If the product needs to be added to two or more ecosystems, go to the device settings page, tap “Enable Pairing Mode,” obtain the pairing code, and add it to the third-party platform.

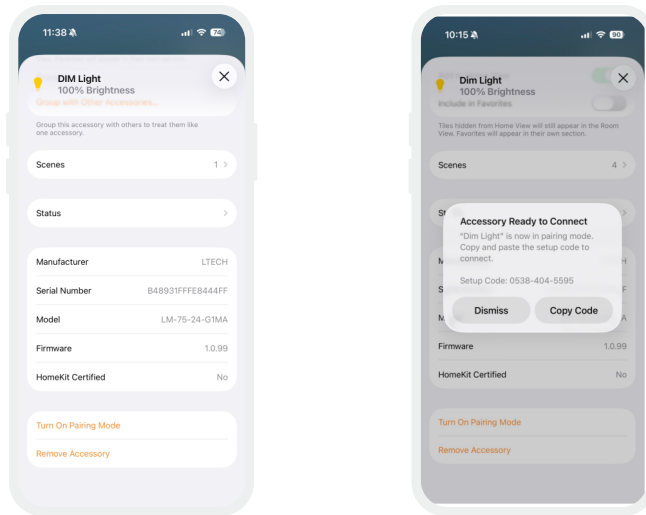

### Reset The Device (Reset to factory defaults)

Make sure the driver is well-connected to a lamp and the lamp is on, turn it off with the switch and after 15s turn it on. After 2s, turn it off again. Repeat the same operation 6 times. When the lamp flashes 5 times , reset the device to factory defaults successfully.

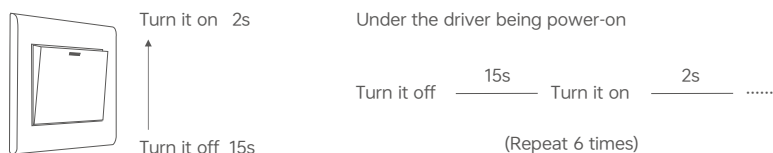

## Use the NFC Lighting APP

Scan the QR code below with your mobile phone and follow the prompts to complete the APP installation (According to performance requirements, you need to use a NFC-capable Android phone, or an iPhone 8 and later that are compatible with iOS 13 or higher).



\* Before you begin setting the parameters of the driver, please make sure the driver is powered off.

### Read/Write the LED driver

Use your NFC-capable phone to read LED driver data, then edit the parameters and they can be directly written to the driver

#### 1. Read the LED driver

On the APP home page, click [Read/Write LED driver], then keep the programmer's sensing area close to the NFC sensing area of the driver to read the driver parameters.

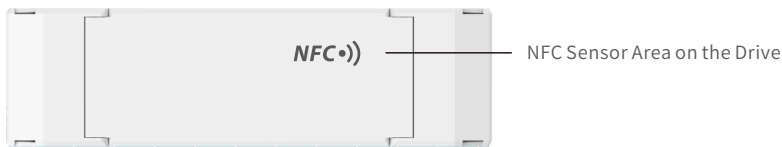

#### 2. Edit parameters

Click on [Parameter Management] to edit more advanced parameters such as Output Current, On/Off Dimming Fade Time, Power-on Fading Time, Brightness Range, Power-on Status.

#### 3. Write to the drive

After completing the parameter settings, click [Write] in the upper right corner, and keep the programmer's sensing area close to the NFC sensing area of the driver, so the parameters can be written to the driver.

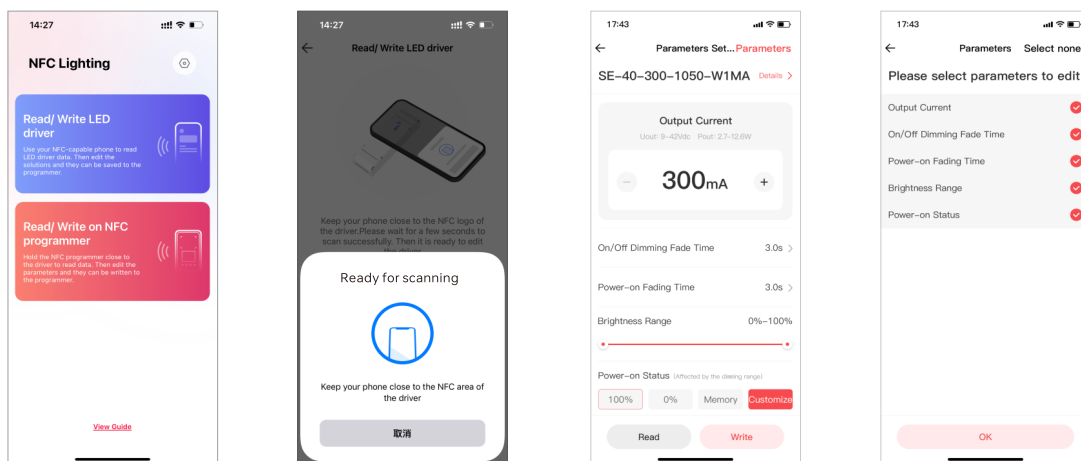

## 包装规格

Model	SE-40-300-1050-W1MA	SE-30-200-800-W1MA
Carton Dimensions	320×275×106mm(L×W×H)	320×275×106mm(L×W×H)
Quantity	20PCS/Layer; 2Layer/Carton; 40PCS/Carton	20PCS/Layer; 2Layer/Carton; 40PCS/Carton
Weight	0.17kg/PC; 7.6kg±5%/Carton	0.15kg/PC; 6.8kg±5%/Carton

## Packaging Style Drawing

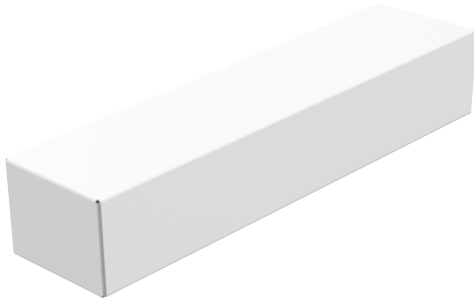

Inner packaging box



Full box packaging

## Transportation and Storage

### 1. Transportation

Products can be shipped via vehicles, boats and planes.

During transportation, products should be protected from rain and sun. Please avoid severe shock and vibration during the loading and unloading process.

### 2. Storage

The storage conditions should comply with the Class I Environmental Standards. The products that have been stored for more than six months are recommended to be re-inspected and can be used only after they have been qualified.

## Attentions

- Product installation and commissioning should be done by a qualified professional.
- LTECH products are and not lightningproof non-waterproof (special models excepted). Please avoid the sun and rain. When installed outdoors, please ensure they are mounted in a water proof enclosure or in an area equipped with lightning protection devices.
- Good heat dissipation will prolong the working life of products. Please ensure good ventilation.
- Please check if the working voltage used complies with the parameter requirements of products.
- The diameter of wire used must be able to load the light fixtures you connect and ensure the firm wiring.
- Before you power on products, please make sure all the wiring is correct in case of incorrect connection that causes damage to light fixtures.
- If a fault occurs, please do not attempt to fix products by yourself. If you have any question, please contact your suppliers.
- \* This manual is subject to changes without further notice. Product functions depend on the goods. Please feel free to contact our official distributors if you have any question.

## Warranty Agreement

- Warranty periods from the date of delivery: 5 years.
- Free repair or replacement services for quality problems are provided within warranty periods.

Warranty exclusions below:

- Beyond warranty periods.
- Any artificial damage caused by high voltage, overload, or improper operations.
- Products with severe physical damage.
- Damage caused by natural disasters and force majeure.
- Warranty labels and barcodes have been damaged.
- No any contract signed by LTECH.

1. Repair or replacement provided is the only remedy for customers. LTECH is not liable for any incidental or consequential damage unless it is within the law.

2. LTECH has the right to amend or adjust the terms of this warranty, and release in written form shall prevail.

## Update Log

Version	Updated Time	Update Conten	Updated by
A0	20251225	Original version	Haipeng Li

LED智能调光驱动器 (恒流型)

- 思创/三星PC阻燃V0级原料外壳，超小体积、轻薄、免螺丝盖设计；
- Matter认证设备，通过IPv6 Thread网络进行通信，需要搭配具备Thread边界路由功能的Matter中枢使用（如Apple HomePod mini或Google NestHub）；
- 支持主流Matter智能家居平台控制，包括 Apple Home、Google Home等，并支持语音控制；
- 通过扫描二维码轻松配对和调试；
- 支持Matter标准OTA升级；
- 支持NFC编程更改输出电流、开/关调光渐变时间、亮度范围等参数；
- T-PWM超深度调光技术，调光深度可达0.0001%；
- 0-100%全程调光无可视频闪，高频豁免考核级别；
- 带软启动渐亮功能，让人眼视觉更舒服；
- 欧盟ERP空载功耗、网络待机功耗 < 0.5W；
- 空载保护，防止接触不良损坏LED灯具；
- 过温、过载、短路保护，可自动恢复；
- 适合室内I、II、III类灯具应用；
- 常规使用下寿命可达10万小时；
- 5年保修期（采用红宝石电容）。

调光  
无频闪  
IEEE 1789  
高频豁免级别  
T-PWM  
超深度调光技术

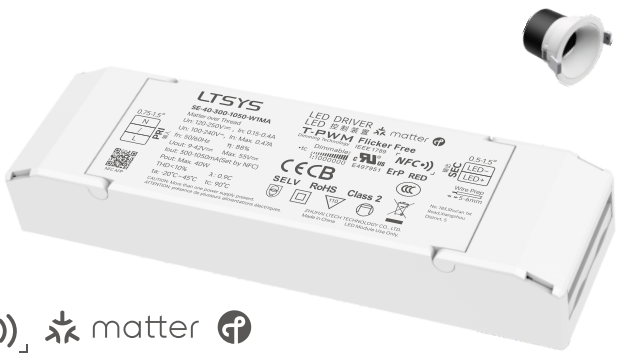

Dimmable: 1:1000000

NFC, Matter, Matter logo

CE, CB, CCC, cULus E497951, ErP RED, Class 2, SELV RoHS, 110, Overload protection, Short circuit protection

技术参数

型号	SE-40-300-1050-W1MA	SE-30-200-800-W1MA			
特征	输出类型	恒流			
	调光接口	Matter over Thread			
	输出特征	隔离			
	防护等级	IP20			
	绝缘等级	II类 (适用于室内I、II、III类灯具)			
输出	输出电压	9-42V $\equiv$			
	最大输出电压(空载)	$\leq 55V \equiv$			
	工作电流范围	300-1050mA(通过手机APP NFC设置更多电流, 步进值低至1mA; 默认: 300mA)	200-800mA (通过手机APP NFC设置更多电流, 步进值低至1mA; 默认: 200mA)		
	负载功率范围	2.7W~40W	1.8W~30W		
	调光范围	0-100%, 调光深度: Max. 0.0001%(通过手机APP NFC设置更多档位, 默认:0.01%)			
	电流纹波	<3%(输出最大电流非调光状态)			
	电流精度	$\pm 5\%$			
	PWM频率	$\leq 3600Hz$			
输入	直流电压范围	120-250V $\equiv$			
	交流电压范围	100-240V~			
	应急输出系数	EoF <sub>i</sub> =100%			
	额定电压	115V~ /230V~			
	频率范围	0/50/60Hz			
	输入电流	$\leq 0.45A/115V \sim$ , $\leq 0.22A/230V \sim$	$\leq 0.34A/115V \sim$ , $\leq 0.17A/230V \sim$		
	功率因数	PF>0.95/115V~ (满载), PF>0.9C/230V~ (满载)			
	谐波THD	THD $\leq 10\%/230V \sim$ (满载)			
	效率(Typ.)	88%@950mA (满载)	87%@750mA (满载)		
	浪涌电流	冷启动, 25A (在50%I <sub>peak</sub> 下测t <sub>width</sub> =130us)@230V~			
	抗浪涌	L-N: 2KV			
漏电流	Max. 0.5mA				
环境	工作温度	ta: -20 ~ 45°C tc: 90°C			
	工作湿度	20 ~ 95%RH, 无冷凝			
	储存温度/湿度	-40 ~ 80°C/10~95%RH			
	温度系数	$\pm 0.03\%/^{\circ}C(-20-45^{\circ}C)$			
保护	耐振动	10-500HZ, 2G 12分钟/周期, X, Y, Z轴各72分钟			
	过载保护	负载超过额定功率 $\geq 1.02$ 倍时自动保护, 减轻负载自动恢复			
	过温保护	根据PCB温度超标情况( $\geq 110^{\circ}C$ ), 智能调节电流输出或关闭, 可自动恢复; PCB温度 < 90°C时, 可自动恢复正常输出			
	过压保护	超过空载电压值进入保护, 可自行恢复			
安规和电磁规格	短路保护	输出线路短路进入打嗝模式, 可自动恢复			
	耐压	输入对输出:	3750V~		
		绝缘阻抗	输入对输出: 100M $\Omega$ /500VDC/25°C/70%RH		
		安全规范	CCC	中国	GB19510.1, GB19510.14, GB19510.213
			CB	成员国	IEC61347-1, IEC61347-2-13
			CE	欧盟	EN61347-1, EN61347-2-13, EN62384
	CUL		加拿大	CSA C22.2 No.250.13	
	UL	美国	UL 8750		
	电磁兼容发射	CCC	中国	GB/T17743, GB17625.1	
		CE	欧盟	EN55015, EN61000-3-2, EN61000-3-3, EN61547	
CUL		加拿大	ICES-005		
UL		美国	FCC part 15B		
电磁兼容抗扰度	EN61000-4-2,3,4,5,6,8,11, EN61547				
ErP	功耗	网络待机功耗	< 0.5W (通过指令开关后)		
		空载功耗	< 0.5W (不接灯具时)		
	频闪/频闪效应	IEEE 1789	满足无影响/高频豁免考核级别		
		CIE SVM	Pst LM $\leq 1.0$ , SVM $\leq 0.4$		
	DF	相位因素	DF $\geq 0.9$		
其他	产品重量	170g $\pm 10g$	150g $\pm 10g$		
	产品尺寸	142 $\times$ 40 $\times$ 23mm(L $\times$ W $\times$ H)			

典型电流对应参数表

下图典型16组电流数据供选型参考，均可通过手机APP NFC设置更多电流，可设置范围在300-1050mA，电流步进值低至1mA

SE-40-300-1050-W1MA	输出电流	300mA	350mA	400mA	450mA	500mA	550mA	600mA	650mA
	输出电压	9-42Vdc	9-42Vdc	9-42Vdc	9-42Vdc	9-42Vdc	9-42Vdc	9-42Vdc	9-42Vdc
	输出功率	2.7-12.6W	3.15-14.7W	3.6-16.8W	4.05-18.9W	4.5-21W	4.95-23.1W	5.4-25.2W	5.85-27.3W
	输出电流	700mA	750mA	800mA	850mA	900mA	950mA	1000mA	1050mA
	输出电压	9-42Vdc	9-42Vdc	9-42Vdc	9-42Vdc	9-42Vdc	9-42Vdc	9-40Vdc	9-38Vdc
	输出功率	6.3-29.4W	6.75-31.5W	7.2-33.6W	7.65-35.7W	8.1-37.8W	8.54-39.9W	9-40W	9.45-40W

下图典型13组电流数据供选型参考，均可通过手机APP NFC设置更多电流，可设置范围在200-800mA，电流步进值低至1mA

SE-30-200-800-W1MA	输出电流	200mA	250mA	300mA	350mA	400mA	450mA	500mA	550mA
	输出电压	9-42Vdc	9-42Vdc	9-42Vdc	9-42Vdc	9-42Vdc	9-42Vdc	9-42Vdc	9-42Vdc
	输出功率	1.8-8.4W	2.25-10.5W	2.7-12.6W	3.15-14.7W	3.6-16.8W	4.05-18.9W	4.5-21W	4.95-23.1W
	输出电流	600mA	650mA	700mA	750mA	800mA	/	/	/
	输出电压	9-42Vdc	9-42Vdc	9-42Vdc	9-40Vdc	9-37.5Vdc	/	/	/
	输出功率	5.4-25.2W	5.85-27.3W	6.3-29.4W	6.75-30W	7.2-30W	/	/	/

尺寸图

单位: mm

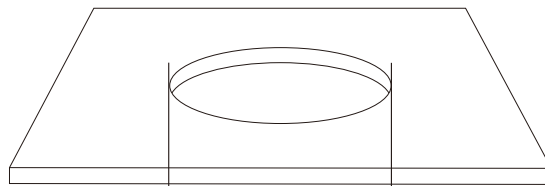
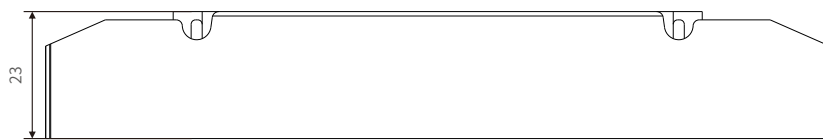
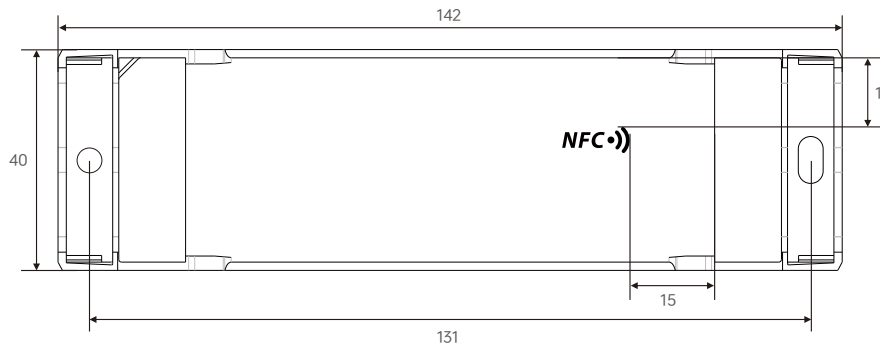

产品: 48mm      开孔尺寸:  $\phi$  50-52mm

## 连接应用图

### 无线连接方式

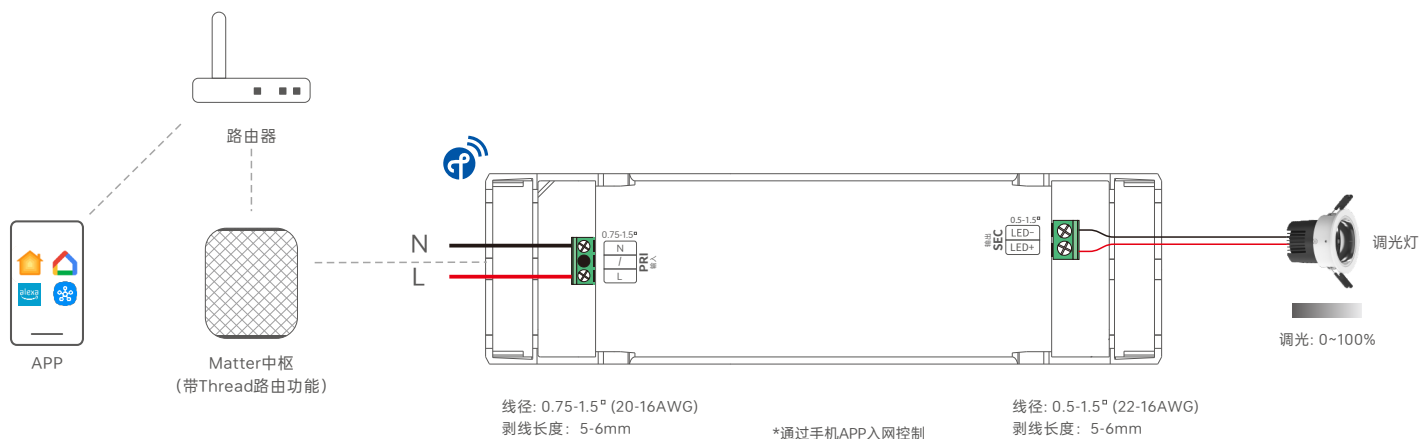

## 保护盖应用图

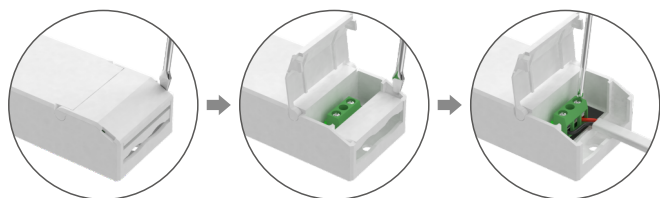

1. 在侧板处使用螺丝批撬起保护盖，并撬起压线板将其拆下后，按照接线图进行接线。

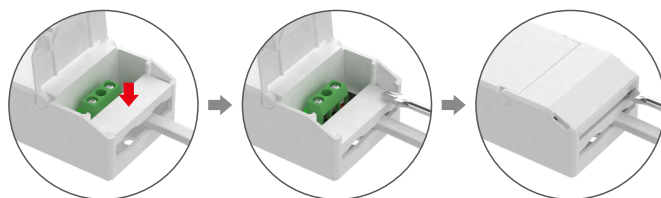

2. 装上压线板并向下按压，使用小一字螺丝批按住压线板的同时，将保护盖向下扣合即可。

## 安装注意事项

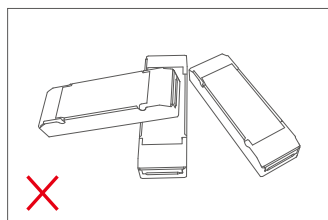

请勿将产品堆叠摆放，产品与产品间隔距离应 $\geq 15\text{cm}$ ，避免影响产品散热和使用寿命。

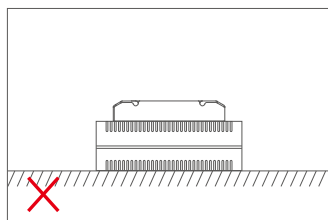
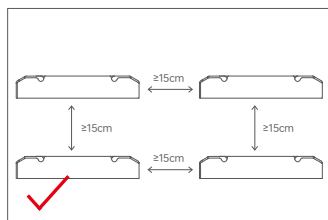

请勿将产品置于电源上方，产品与电源间隔距离应 $\geq 15\text{cm}$ ，避免影响产品散热而减少使用寿命。

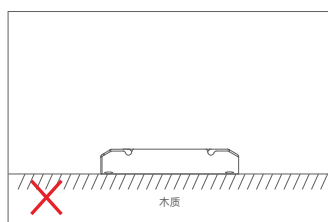
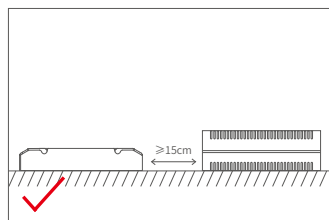

请勿将产品螺丝固定紧贴于木板，应在固定螺丝下增加 $\geq 7\text{mm}$ 的垫片，留点空隙可以有效散热，避免影响产品散热和使用寿命。

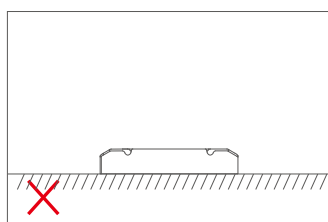
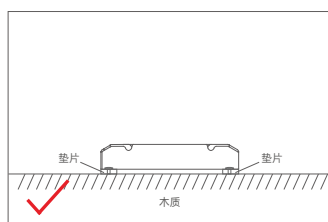

请勿将产品放置在地面上。产品与地面之间的距离应 $\geq 100\text{cm}$ ，以免信号干扰影响使用。

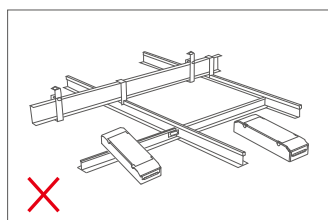
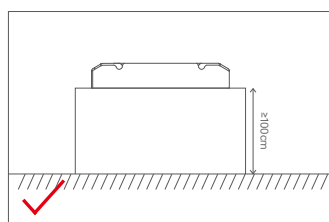

请勿将产品大面积接触金属物体(如: 龙骨架), 间隔距离应 $\geq 15\text{cm}$ ，以免信号干扰影响使用。

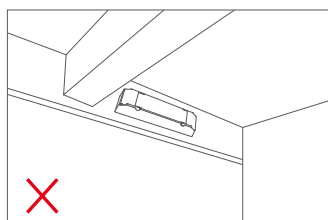
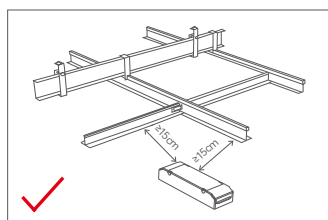

请勿将产品安装在横梁、墙角等位置，间隔距离应 $\geq 15\text{cm}$ ，以免信号干扰影响使用。

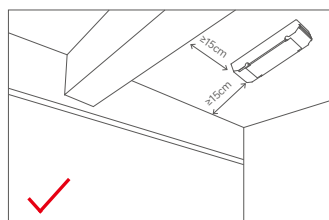

关系图表

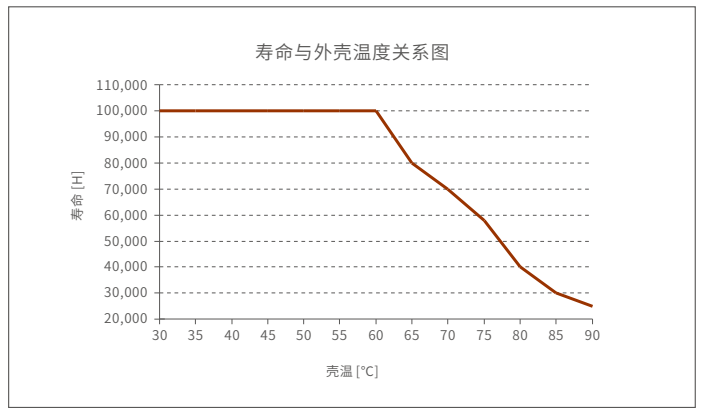
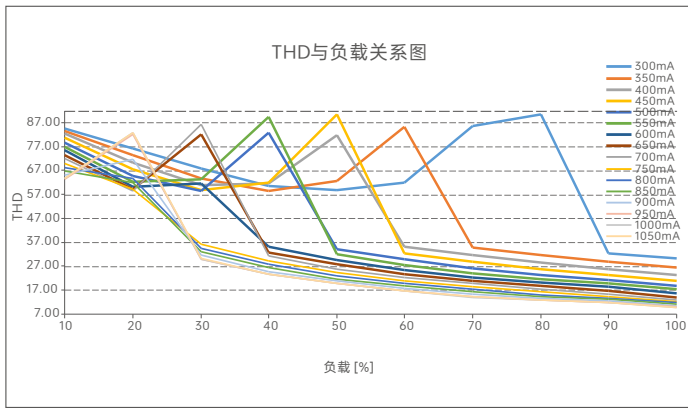
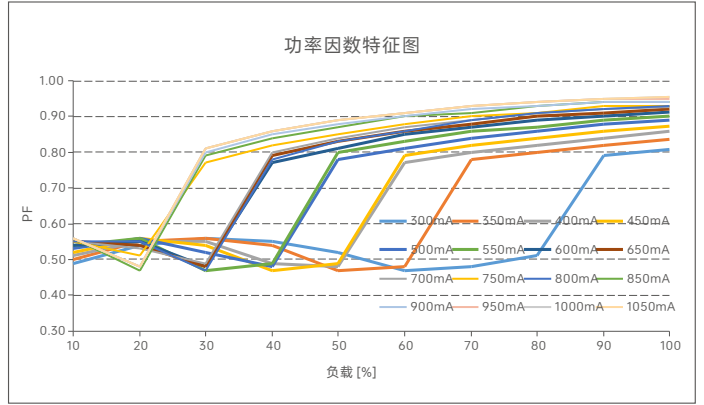
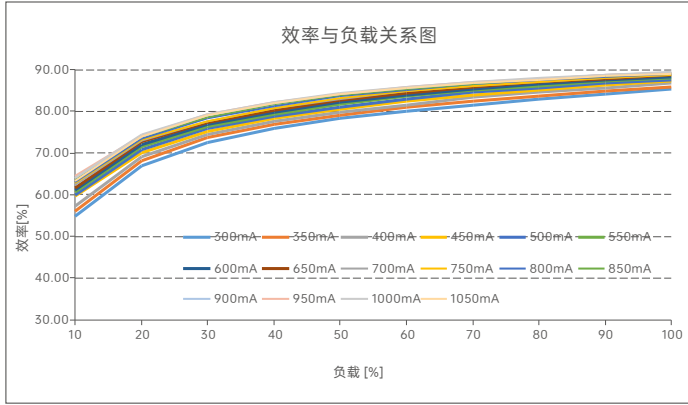

SE-40-300-1050-W1MA

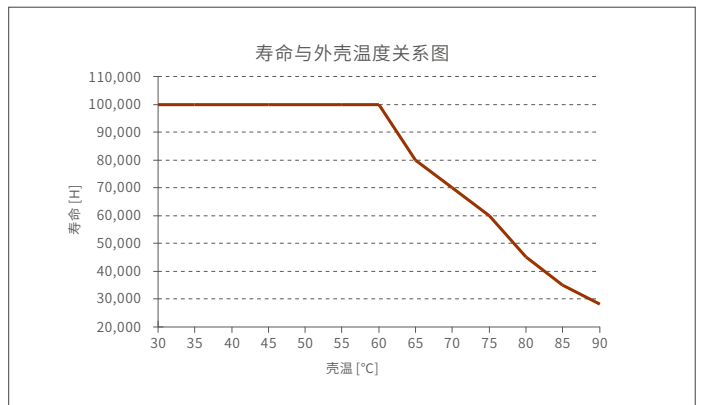
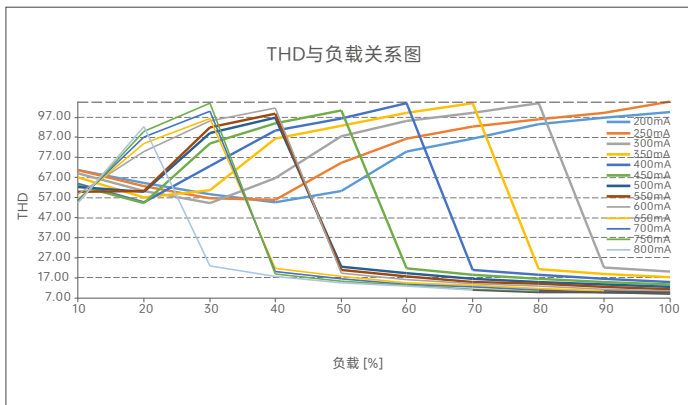
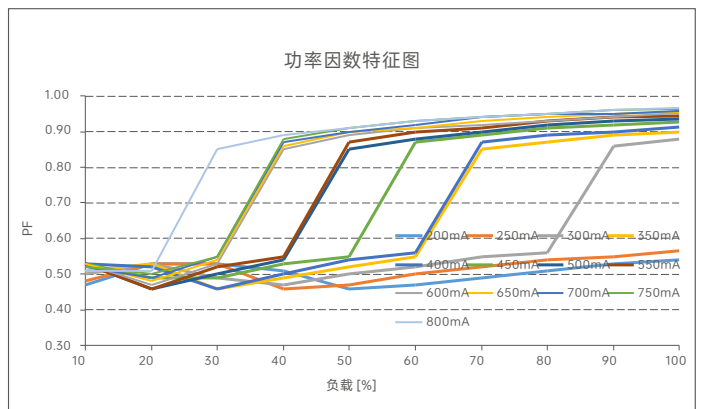
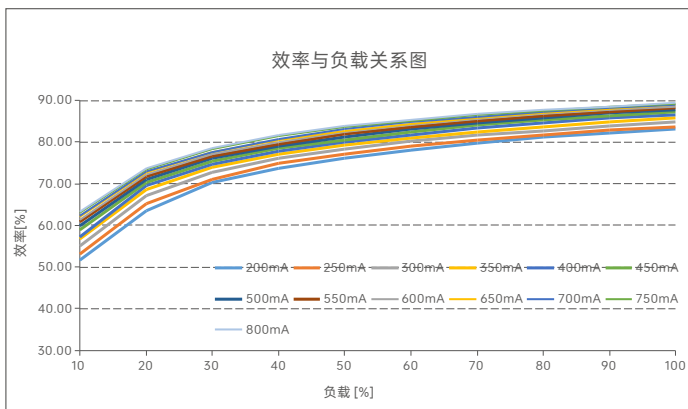

SE-30-200-800-W1MA

浪涌电流&对应的微型断路器(MCB)下挂载的数量对应表

微型断路器型号	B10	B13	B16	B20	B25	C10	C13	C16	C20	C25	D10	D13	D16	D20	D25
最大带载数量	15	19	24	30	40	17	22	27	35	43	20	25	31	39	49

备注:

- 1.本数据测试条件: 冷启动, 25A (在50%peak下测twidth=130us)@230Vac
- 2.对于不同品牌和型号的微型断路器, 驱动器的数量会有所不同;
- 3.现场安装时建议不要超过上述数量, 具体负载量以现场安装为准;
- 4.当微型断路器的安装环境温度超过30°C或多个微型断路器并排安装时, 安装的驱动器数量将减少, 这需要重新计算;
- 5.电工通常考虑将B型MCB用于家用照明, 将C型MCB用于商业照明;
- 6.不同仪器设备测试出来的电流峰值和脉冲宽度有差异, 请使用专业仪器设备测试;

频闪测试表

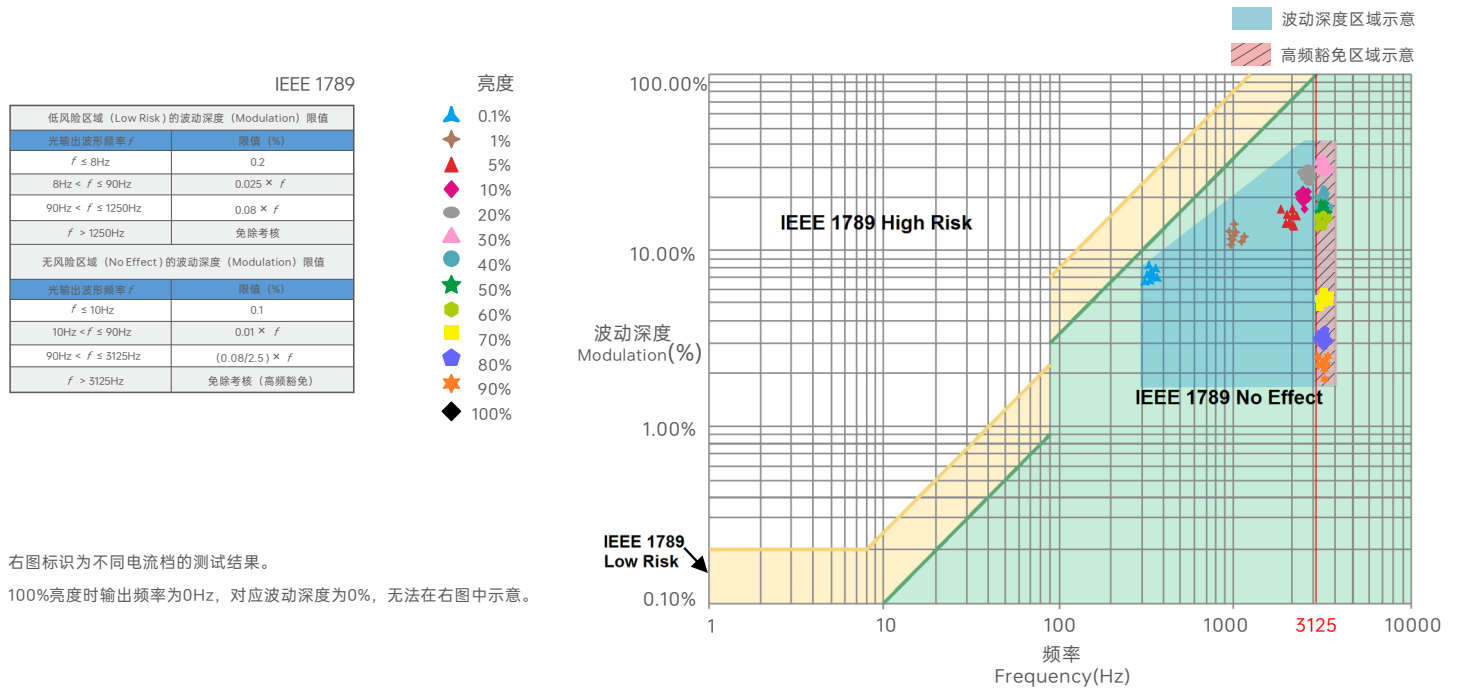

右图标识为不同电流档的测试结果。

100%亮度时输出频率为0Hz, 对应波动深度为0%, 无法在右图中示意。

添加到Matter平台说明

- 1.本设备支持各大主流智能家居平台控制, 包括Apple Home、Amazon Alexa、Google Home、SmartThings等。
- 2.要连接Matter over Thread设备, 需要准备各大平台支持Thread边界路由功能的Matter中枢, 型号可以查看下图。

Apple Home	Google Home	Amazon Alexa	SmartThings
Apple HomePod (second-gen)	Google Nest Hub (2nd Gen)	Amazon Echo (4th-gen)	Aeotec SmartThings Smart Home Hub
Apple HomePod Mini	Google Nest Hub Max	Amazon Echo Hub	Samsung SmartThings Station
Apple TV 4K (2nd gen)	Google Nest Wifi Pro	Amazon Echo Show 8 (3rd-gen)	Samsung SmartThings Hub Dongle
Apple TV 4K (3rd gen,128 GB)	Google TV Streamer (4K)	Amazon Eero 6, Pro 6, 6 Plus, Max 7 etc.	Samsung SmartThings Hub v3

3.本说明书以Apple Home为例, 请先准备一台装有最新版本固件的 iPhone (iOS 16.2 或更高版本) 或 iPad (iPadOS 16.2 或更高版本), 以及一台装有最新版本固件的 Apple HomePod mini。然后将 iPhone 或 iPad 连接到您的家庭 WLAN 网络, 运行 Apple Home 应用程序并按照 Apple 的指示设置 HomePod mini。

\*如苹果手机型号是iphone 16及以上, 则无需Matter中枢, 可直接添加。

Matter系统图

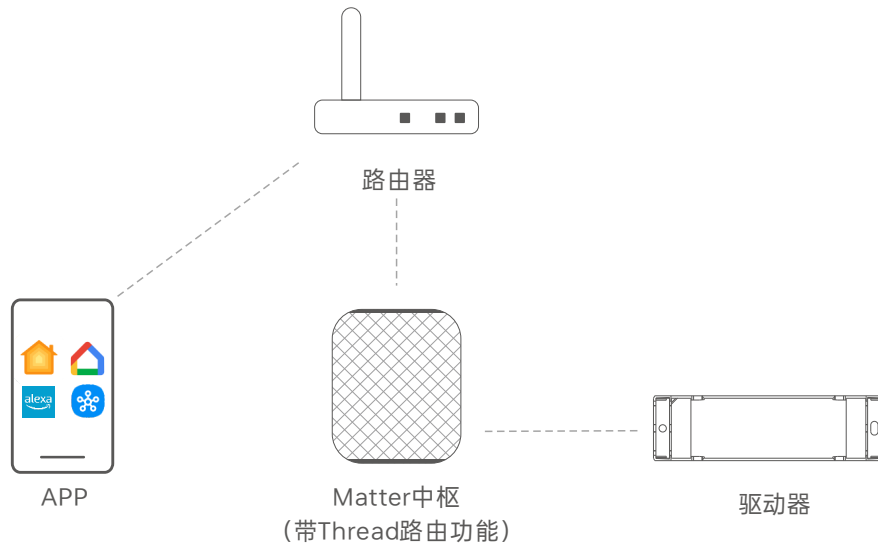

添加步骤

1. 添加配件

打开苹果“家庭” app，并点击“添加或扫描配件”，通过扫描设备上的二维码贴纸，将设备添加到“家庭”APP，如下图所示。

\*也可以通过NFC入网：打开“家庭”APP靠近设备的NFC感应区域，识别入网。



2. 控制设备

成功添加设备后，点击设备图标进行开/关；点击设备卡片进入亮度控制界面。



### 3. 高级功能

支持创建组、场景、自动化、进行远程控制和定时控制，也可以通过Siri语音指令控制设备。



### 4. 多生态配网

如果产品需要加入到两个或者多个生态，可以进入设备设置页，点击“打开配对模式”，获取配对码并添加到第三方平台。

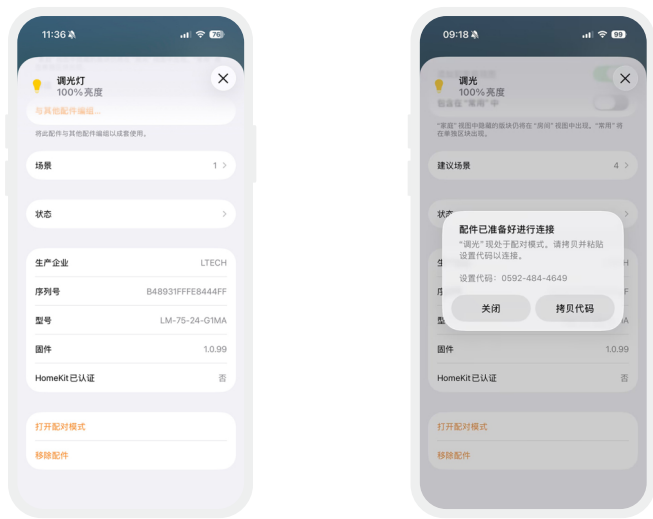

### 恢复出厂设置

确保设备已接灯且处于常亮状态下，使用开关让设备连续通电6次(每次断电时间15秒，通电2秒)，第6次通电2秒后，灯具闪烁5次，即表示设备已恢复出厂设置状态。

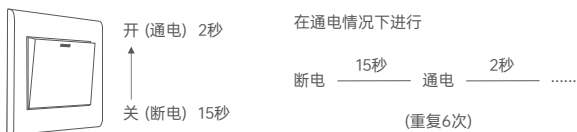

### 搭配 NFC Lighting APP 使用

通过手机扫描下方二维码，按提示完成APP安装。

(因性能需求，要求手机型号苹果：iPhone 8及以上、且操作系统iOS13及以上； 安卓：具备NFC功能机型)



\* 设置驱动器参数时，必须在驱动器断电情况下进行操作。

### 读/写智能电源

使用手机，通过NFC读取驱动器信息，根据需求设置参数后，可直接写入驱动器。

#### 1. 读取驱动器

在APP“首页”点击【读/写智能电源】，将手机感应区域靠近驱动器NFC感应区，读取驱动器参数。



#### 2. 编辑参数

点击【参数管理】可编辑开/关调光渐变时间、通电渐变时间、亮度范围、通电状态、PWM频率等更多高级参数。

#### 3. 写入驱动器

参数设置完成后，点击【写入】，将手机感应区域靠近驱动器NFC感应区，写入驱动器成功修改参数，设备重新上电后即可生效。

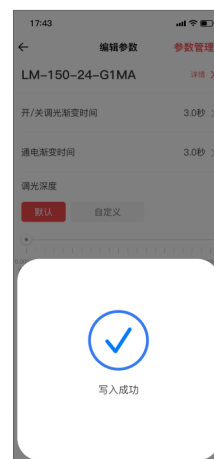
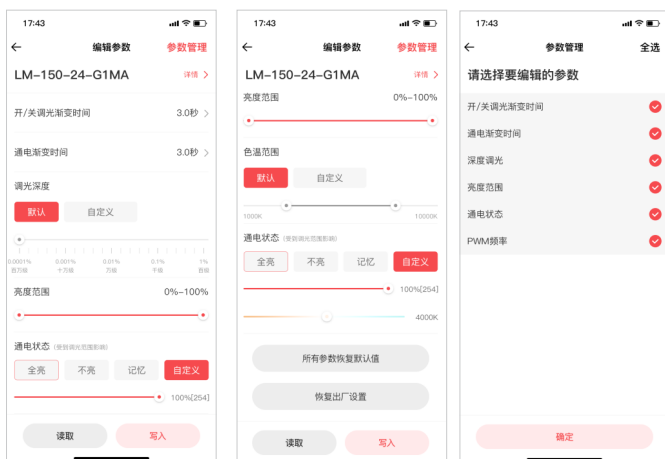

## 包装规格

型号	SE-40-300-1050-W1MA	SE-30-200-800-W1MA
包装箱尺寸	320×275×106mm(L×W×H)	320×275×106mm(L×W×H)
数量	20PCS/层; 2层/箱; 40PCS/箱	20PCS/层; 2层/箱; 40PCS/箱
重量	0.17kg/PC; 7.6kg±5%/箱	0.15kg/PC; 6.8kg±5%/箱

## 包装样式图

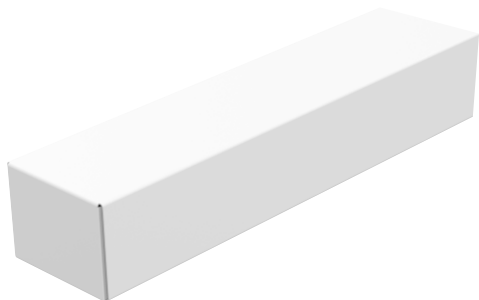

内包装盒



整箱包装

## 运输和贮存

### 1. 运输

产品适用车、船、飞机交通运输工具运输。

在运输中，应使用遮蓬进行防雨和防晒，并保持文明装卸，不应有剧烈振动、撞击等。

### 2. 贮存

贮存符合I类环境的规定。贮存期限超过6个月的产品建议重新检验，合格后方可使用。

## 注意事项

- 请由具有专业资格的人员进行调试安装;
- 雷特产品(专有型号除外)不能防水,需避免日晒雨淋,如安装在户外,请用防水箱;
- 良好的散热条件会延长产品的使用寿命,请把产品安装在通风良好的环境;
- 请检查使用的工作电压是否符合产品的参数要求;
- 使用的电线直径大小必须能够负载连接的LED灯具,并确保接线牢固;
- 通电调试前,应确保所有接线正确,以避免因接线错误而导致灯具损坏;
- 如果发生故障,请勿私自维修;如有疑问,请联系供应商。

\* 本说明书的内容如有变更,恕不另行通知。若内容与您使用的功能有所不同,则以实物为准。如有疑问,欢迎向我司授权的经销商咨询。

## 保修条例

- 自出厂之日起保修服务期为5年。
- 在保修服务期内出现产品质量问题雷特科技将给予免费修理或更换服务。

非保修条例:

属下列情况不在免费保修或更换服务范围之内:

- 已经超出保修服务期;
- 过高电压、超负载、操作不当等人为造成的损坏;
- 产品外形严重损坏或变形;
- 自然灾害以及人力不可抗拒原因造成的损坏;
- 产品保修标签和产品唯一条形码损坏;
- 无雷特科技签订的合同或发票凭证。

1. 修理或更换是雷特科技对客户唯一补救措施。雷特科技不承担任何附带引起的损害赔偿,除非在适用法律范围之内。

2. 雷特科技享有修正或调整本保修条款的权利,并以书面形式发布为准。

珠海雷特科技股份有限公司

地址: 珠海市香洲区水岸一路183号

网址: www.ltech.cn

## 更新日志

版本	更改日期	更改内容	更改人
A0	2025.11.05	正稿	黎海鹏